

10/4/2017 5:05:18 PM C:\Data File\Revit\2016\1483101 Circle 75 IL R16-C\_painm1.rvt

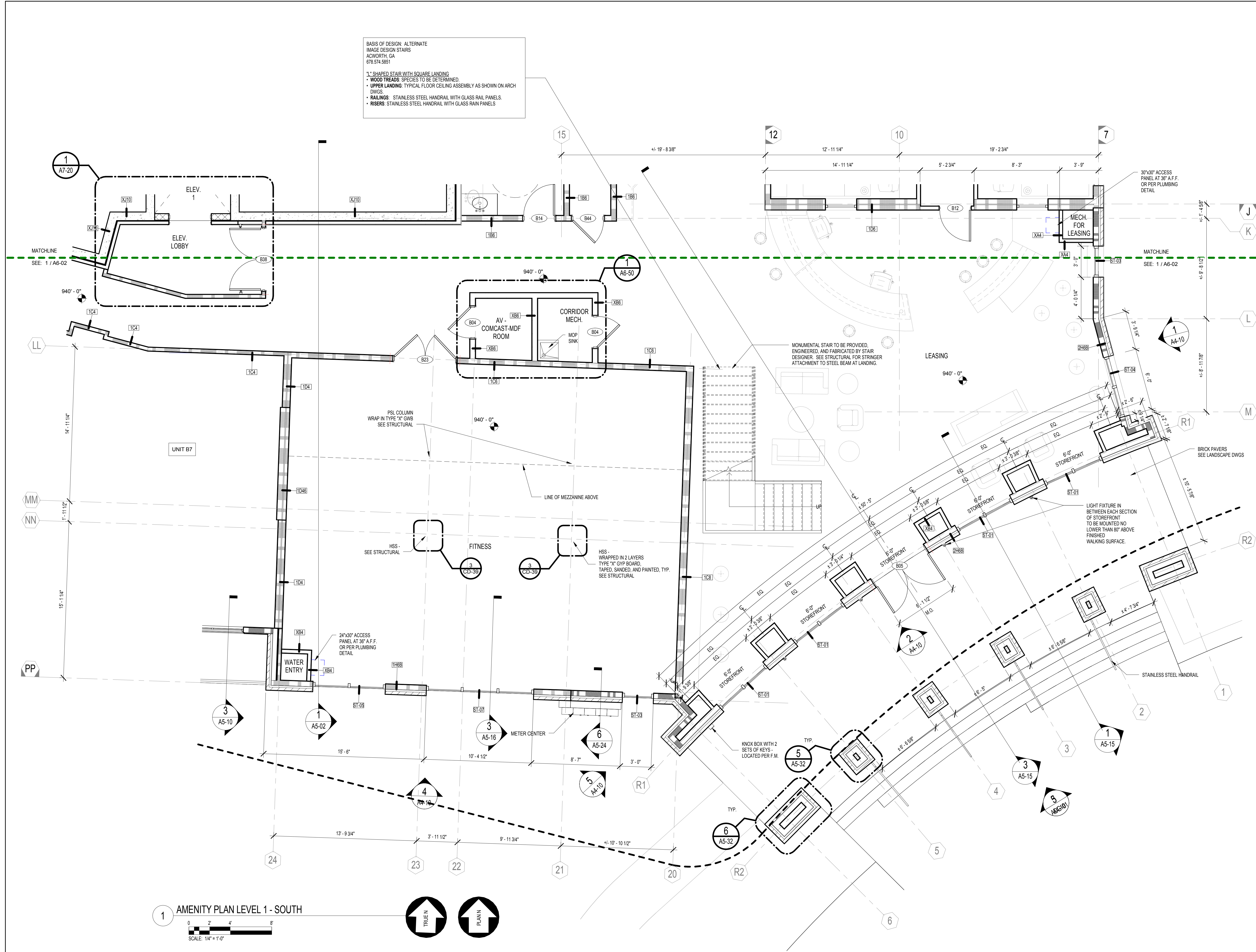

CMU WALL

CONCRETE WALL

UNIT INTERIOR NON-RATED WALLS. 1 HR. RATED IF LOAD BEARING. REFER TO STRUCTURAL DRAWINGS.

UNIT EXTERIOR WALLS TO BE ONE HOUR RATED UNLESS NOTED OTHERWISE

1 HOUR FIRE RATED WALL

2 HOUR RATED WALL

UNIT ADDRESS - SEE AD-01

RESIDENTIAL UNIT TYPE

LOCATION OF ENLARGED ARCH. PLAN, RCP AND INTERIOR ELEVATIONS

WINDOW TYPE (SEE SHEET A6-05)

GENERAL NOTES

1. REFER TO A3 SERIES FOR ENLARGED RESIDENTIAL UNIT PLANS, DOOR AND WINDOW TYPES AND LOCATION, RESIDENTIAL UNIT ROPS, ETC.

2. REFER TO SHEET CD-30 FOR WALL ASSEMBLY TYPES AND ADDITIONAL INFORMATION.

3. REFER TO SHEET A8-01 FOR DOOR SCHEDULE.

4. ALL SLOPES TO BE 1/8" UNLESS NOTED OTHERWISE.

5. REFER TO INTERIOR DRAWINGS FOR LIGHTING LAYOUTS AND FINISH SPECIFICATIONS.

6. REFER TO BUILDING SECTIONS FOR CORRIDOR FINISHES.

7. EXPANSION JOINTS IN BREEZEWAY/CORRIDOR CEILING TO BE 30'-0" O.C. MAX.

8. DOOR LOCATIONS NOT DIMENSIONED SHALL BE LOCATED AT MIDPOINT OF WALL OR 4" CLEAR OF ROOM FROM ADJACENT WALL CORNER TO HINGE SIDE, TYPICAL.

9. ALL BALCONY SLABS TO SLOPE AWAY FROM BUILDING AT 1/4" PER FT. MIN.

10. ALL BALCONIES TO BE CONSTRUCTED OF FRT WOOD AND TO BE 1-HOUR PROTECTED, MINIMUM, WHEN WITHIN 4'-0" OF THE 3-HR FIREWALLS.

ELEVATOR NOTES

NO ELEVATOR LOBBY REQUIRED AT LEVELS 2 - 5 AT BUILDING 1000B

ELEVATOR LOBBY OF DESIGNATED FLOOR TO BE ON LEVEL 1

LEVEL 6 FLOOR TO HAVE ALTERNATE LEVEL ELEVATOR LOBBY SEPARATE FROM REMAINDER OF BUILDING 1000B WITH 1-HR FIRE RATED WALL CONSTRUCTION PER IBC 713.14.2

ERCA = EMERGENCY RESPONSE. COMMUNICATION AS REQUIRED BY F.M. FIELD TEST

THE PRESTON PARTNERSHIP, LLC

A MULTI-DISCIPLINARY DESIGN FIRM

SOUTH TERRACES

115 PERIMETER CENTER PLACE, SUITE 950

ATLANTA, GEORGIA 30346

TELEPHONE: 770 396 7248

FAX: 770 396 2945

WWW.THEPRESTONPARTNERSHIP.COM

CONSULTANT

SEAL

STATE OF GEORGIA

REGISTERED ARCHITECT

ROBERT N. PRESTON

EXPIRATION DATE 08/31/2017

PROJECT

RESERVE AT THE BALLPARK, PHASE II, AKA REVEL AT THE BALLPARK

2885 CRESCENT PKWY

SMYRNA, GA 30080

FOR

ATLANTIC REALTY PARTNERS

3438 PEACHTREE ROAD

SUITE 1425

ATLANTA, GA 30326

ISSUES & REVISIONS

NO.	DATE	REVISIONS
1	08/21/2015	CONCEPTUAL DESIGN
2	09/28/2015	SCHEMATIC DESIGN
3	10/15/2015	CMIP-DESIGN DEVELOPMENT
4	04/03/2017	GMP
5	05/22/2017	PERMIT SET
6	07/25/2017	2. ADA COMMENTS / COORDINATION
7	07/25/2017	3. BUILDING PERMIT

DATE

05/22/2017

JOB NUMBER

1493101

DRAWN BY

EKS/NB

CHECKED BY

CW

SHEET TITLE

AMENITY PLAN LEVEL 1 - SOUTH

SHEET NUMBER

A6-01

COMMENTS

BUILDING PERMIT RE-SUBMISSION

30X42

© 2017 The Preston Partnership, LLC

KEYPLAN