

3 CODE DATE PARKING DECK LEVEL 6 - PROJECT LEVEL 7
SCALE: 1/32" = 1'-0"

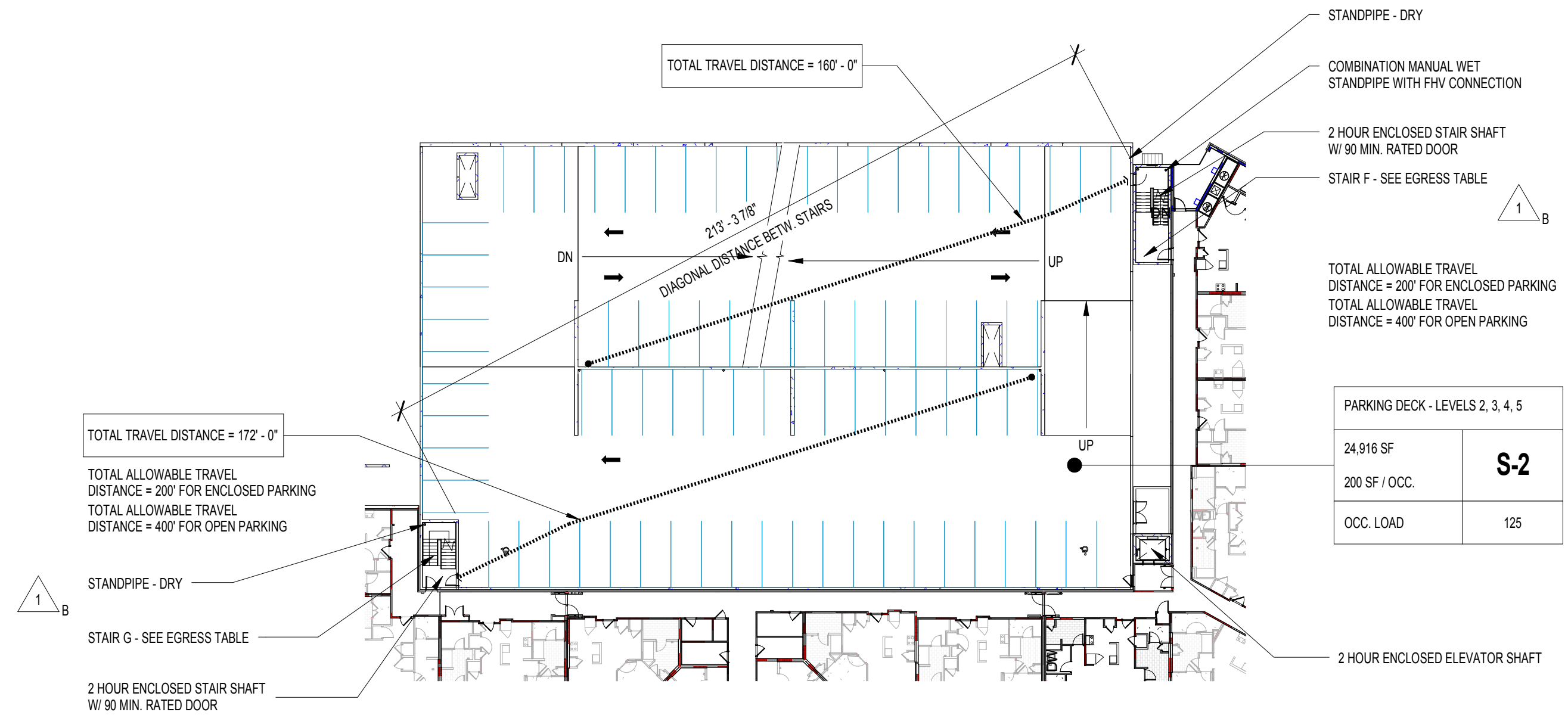

2 CODE DATA PARKING DECK TYP. LEVELS 2-5 - PROJECT LEVELS 3-6
SCALE: 1/32" = 1'-0"

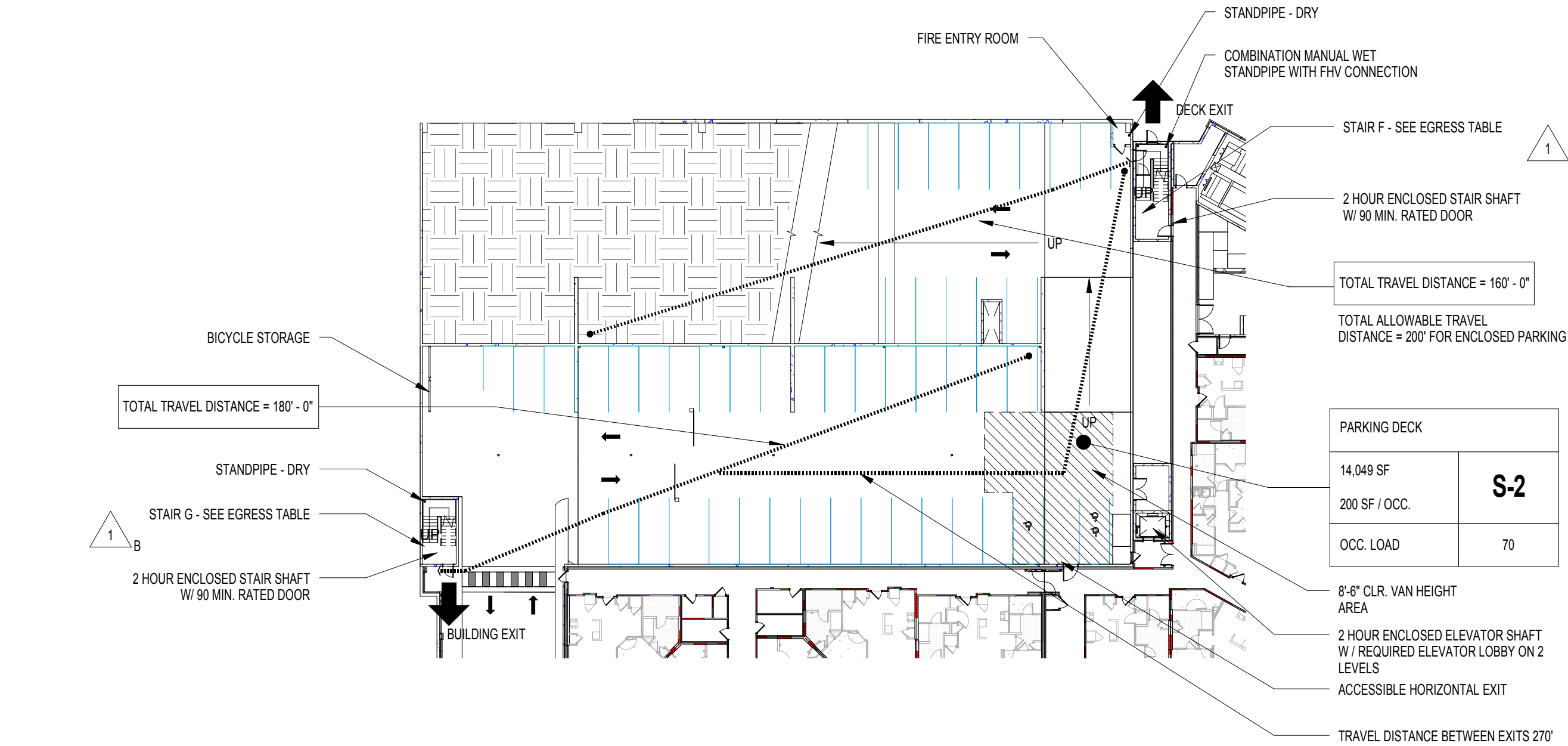

1 CODE DATA PARKING DECK LEVEL 1 - PROJECT LEVEL 2
SCALE: 1/32" = 1'-0"

NOTE:
WHERE TRAVEL FROM A STANDPIPE CONNECTION TO A REMOTE PORTION OF A BUILDING EXCEEDS 200' AND THE HOSE PULL IS GREATER THAN 200 FT., ADDITIONAL STANDPIPE CONNECTIONS ARE REQUIRED. SEE PLUMBING DRAWINGS FOR LOCATIONS.

| STAIR F - EGRESS TABLE | | | | | |
|------------------------|---------------|-----------------|----------------------|---------------|---------------|
| PROJECT LEVEL | PKG DECK OCC. | TOTAL PER LEVEL | BLDG. 1000 OCCUPANCY | PROJECT LEVEL | PROJECT LEVEL |
| 6.5 | 63 | 141 | 78 | 6 | 6 |
| 5.5 | 63 | 141 | 78 | 5 | 5 |
| 4.5 | 63 | 141 | 78 | 4 | 4 |
| 3.5 | 63 | 141 | 78 | 3 | 3 |
| 2.5 | 63 | 141 | 113 | 2 | 2 |

VERTICAL EXIT CALCS.
STAIR EGRESS OPENING REQUIREMENT WIDTH FOR 113 OCCUPANTS @ 0.3 VER. = 34"
STAIR WIDTH PROVIDED = 52"
DOOR EGRESS OPENING REQUIREMENT WIDTH FOR 141 OCCUPANTS @ 0.2 VER. = 28.2"
DOOR CLEAR OPENING PROVIDED = 34"
NOTE: STAIR F CONTINUES BELOW LOWEST LEVEL OF EXIT DISCHARGE. SEE DOOR SCHEDULE FOR STAIR INTERRUPTOR DOOR

| STAIR G - EGRESS TABLE | | | |
|------------------------|---------------|-----------------|---------------|
| OCCUPANCY | PKG DECK OCC. | TOTAL PER LEVEL | PROJECT LEVEL |
| 63 | 63 | | 7 |
| 63 | 63 | | 6 |
| 63 | 63 | | 5 |
| 63 | 63 | | 4 |
| 63 | 63 | | 3 |
| 63 | 63 | | 2 |

VERTICAL EXIT CALCS.
STAIR EGRESS OPENING REQUIREMENT WIDTH FOR 63 OCCUPANTS @ 0.3 VER. = 18.9"
STAIR WIDTH PROVIDED = 52"
DOOR EGRESS OPENING REQUIREMENT WIDTH FOR 63 OCCUPANTS @ 0.2 VER. = 12.6"
DOOR CLEAR OPENING PROVIDED = 34"

NOTE:
TOTAL ALLOWABLE TRAVEL DISTANCE = 400' FOR OPEN PARKING
NOTE:
LEVELS 1 AND 2 ENCLOSED PARKING ALLOWABLE TRAVEL DISTANCE = 200'

| BUILDING SUMMARY - LEVELS | | | | | | |
|---------------------------|--------------|------------|------------|------------|------------|----------|
| PROJECT LEVEL | FFE | BLDG. 1000 | BLDG. 2000 | BLDG. 3000 | BLDG. 4000 | PKG DECK |
| 9 | 1026'-9 1/4" | | | | | 5 |
| 8 | 1016'-1 3/8" | | | | | 4 |
| 7 | 1005'-5 1/2" | | | | | 6 |
| 6 | 994'-9 5/8" | 5 | 5 | 4 | 2 | 5 |
| 5 | 984'-0 1/2" | 4 | 4 | 3 | 1 | 4 |
| 4 | 973'-3 3/8" | 3 | 3 | 2 | 8 | 3 |
| 3 | 962'-4 1/4" | 2 | 2 | 1 | | 2 |
| 2 | 951'-9 1/8" | 1 | 1 | | | 1 |
| 1 | 941'-0" | B | | | | |

BUILDING CODE DATA:

| | | |
|--|---|---|
| BUILDING IDENTIFICATION | | PARKING DECK |
| BUILDING OCCUPANCY CLASSIFICATION (IBC311.1) | | S-2 STORAGE GROUP (OPEN/ENCLOSED PARKING DECK) ORDINARY HAZARD PER NFPA A.6.2.2.3. |
| TYPE OF CONSTRUCTION | | TYPE 2B |
| BUILDING HEIGHT AND AREA | | |
| GENERAL AREA LIMITATION (IBC TABLE 503) | | 50,000 SF (TABULAR BUILDING AREA LIMIT PER STORY) |
| AREA MODIFICATIONS (IBC SECTION 506) | | |
| AREA | FRONTAGE INCREASE (IBC 506.2) | N/A NOT FACTORED |
| | AUTOMATIC SPRINKLER SYSTEM INCREASE (IBC 506.3 IS = 100%) | +48,000 SF MODIFIED (NFPA 13 SPRINKLER) |
| | ALLOWABLE BUILDING AREA PER FLOOR (IBC 506.1) | +43,200 SF (ALLOWED) Aa = 24000 + (24,000 x 0) + (24,000 x 2) = 72,000 SF PER FLOOR |
| | ACTUAL BUILDING AREA PER FLOOR (AS DRAWN) | 14,040 SF @ LEVEL 1; 24,916 SF @ LEVELS 2, 3, 4, 5; 17,086 SF @ LEVEL 6 |
| MAXIMUM AREA OF BUILDING (IBC 503.3) | | 400,000 SF ALLOWED (8 TIERS X 50K PER TIER) |
| MAXIMUM ALLOWED AREA PER FLOOR PLATE (IBC 506.4.1) | | 72,000 X 3/5 STORIES = 43,200/FLOOR |
| TOTAL BUILDING AREA | | 130,809 SF |
| GENERAL HEIGHT LIMITATION (IBC TABLE 406.5.4) | | 8 TIERS (ALLOWED) |
| HEIGHT MODIFICATIONS (IBC SECTION 504) | | |
| HEIGHT | HEIGHT | N/A |
| | NUMBER OF STORIES | N/A |
| MAXIMUM HEIGHT OF BUILDING | | 8 TIERS (ALLOWED) |
| ACTUAL HEIGHT OF BUILDING | | 6 TIERS/69'-0" (ACTUAL) |

| | | |
|--|---|---|
| FIRE - RESISTANCE RATINGS FOR BUILDING ELEMENTS (IBC TABLES 601 & 602) | | |
| FIRE-RESISTANCE | STRUCTURAL FRAME (IBC TABLE 601) | 0-HOUR |
| | EXTERIOR BEARING WALLS (IBC TABLE 601) | 0-HOUR |
| | INTERIOR BEARING WALLS (IBC TABLE 601) | 0-HOUR |
| | EXTERIOR NON-BEARING WALLS (IBC TABLE 602) | |
| | FIRE SEPARATION (DISTANCE = X) X < 5' | 1-HOUR |
| | FIRE SEPARATION (DISTANCE = X) 5' ≤ X < 10' | 1-HOUR |
| | FIRE SEPARATION (DISTANCE = X) 10' ≤ X < 30' | 0-HOUR |
| | FIRE SEPARATION (DISTANCE = X) X ≥ 30' | 0-HOUR |
| | INTERIOR NON-BEARING WALLS (IBC TABLE 601) | 0-HOUR |
| | FLOOR CONSTRUCTION (IBC TABLE 601) | 0-HOUR |
| FIRE-RESISTANCE | ROOF CONSTRUCTION (IBC TABLE 601) | 0-HOUR |
| | STAIRS (LSC 7.2.2) | <input type="checkbox"/> OPEN <input checked="" type="checkbox"/> ENCLOSED |
| | STAIR WIDTH (LSC 7.2.2.2.1(A)) | MIN. REQUIRED: 44" MIN. PROVIDED: 44" |
| | NUMBER OF FLOORS CONNECTED | 6.5 STORIES + ROOF |
| | ELEVATOR LOBBIES REQUIRED (IBC 713.14.1) | <input type="checkbox"/> YES <input checked="" type="checkbox"/> NO <input type="checkbox"/> N/A |
| | FLOOR LOCATIONS | ALL LEVELS - SEE PLANS |
| | FIRE PROTECTION SYSTEM (IBC 903.2.8) | |
| | SPRINKLER SYSTEM (LSC 30.3.3) | REQUIRED <input checked="" type="checkbox"/> YES <input type="checkbox"/> NO <input type="checkbox"/> N/A |
| | | REQUIRED <input checked="" type="checkbox"/> NFPA 13 <input type="checkbox"/> NFPA 13R <input type="checkbox"/> N/A |
| | STAND PIPES REQUIRED | <input checked="" type="checkbox"/> YES (GREATER THAN 30' ABOVE FIRE DEPARTMENT VEHICLE ACCESS) <input type="checkbox"/> NO |
| FIRE-RESISTANCE | FIRE EXTINGUISHERS | TYPE <input checked="" type="checkbox"/> DRY <input type="checkbox"/> WET |
| | | MAX. SEPARATION DISTANCE ALLOWED: 75'-0" (INTERNATIONAL FIRE CODE) |
| | SMOKE SEPARATION / DRAFTSTOPPING | |
| | FLOOR CAVITY (BC 716.3.2) | <input type="checkbox"/> YES <input checked="" type="checkbox"/> NO (NFPA 13 SPRINKLER SYSTEM) |
| | ATTIC AREA (BC 716.4.2) | <input type="checkbox"/> YES <input checked="" type="checkbox"/> NO (NFPA 13 SPRINKLER SYSTEM) |
| | EXITS REQUIRED (IBC 1005.2.1, NFPA 101 CHAPTER 42) | |
| | BUILDING EXITS (LSC 30.2.4.2) | PER FLOOR - 2 MINIMUM WITHIN ALLOWED TRAVEL DISTANCE |
| | HORIZONTAL EXITS (LSC 7.2.4.1.2) | 1 PER BUILDING |
| | TRAVEL DISTANCE: (TO STAIRS) | MAXIMUM ALLOWED (LSC 42.8.2.6.1) 400' (NFPA 13 SPRINKLERED) |
| | | MAXIMUM PROVIDED SEE ADJACENT PLANS |
| FIRE-RESISTANCE | DEAD END CORRIDOR | MAXIMUM DIST. PROVIDED 50' (NFPA 13 SPRINKLER) |
| | | MAXIMUM DIST. PROVIDED SEE ADJACENT PLANS |
| | UNITS OF EGRESS (LSC 7.3.3.1) | REQUIRED: 0.2' PER PERSON (LEVEL) AND 0.3' PER PERSON (STAIRS) |
| | | PROVIDED: (SEE CODE DATA SHEETS) |
| | TRAVEL DISTANCE WITHIN A DWELLING UNIT (LSC 30.2.6.2) | MAXIMUM ALLOWED N/A |
| | COMMON PATH OF TRAVEL LIMITS = 50' (LSC 30.2.5.3.2) | MAXIMUM PROVIDED N/A |
| | ROOF ACCESS (LSC 7.2.2) | <input checked="" type="checkbox"/> STAIR <input type="checkbox"/> LADDER <input type="checkbox"/> N/A |
| | OPENING PROTECTION REQUIRED (BC 704.10) | ASSUMED PROPERTY LINE (LESS THAN 15') <input type="checkbox"/> YES <input checked="" type="checkbox"/> NO |
| | | ADJACENT STRUCT (GREATER THAN 30') <input checked="" type="checkbox"/> YES <input type="checkbox"/> NO |
| | ATTIC VENTILATION REQUIRED (IBC 1203.2) | <input type="checkbox"/> YES <input type="checkbox"/> NO <input checked="" type="checkbox"/> N/A |
| FIRE-RESISTANCE | | <input type="checkbox"/> PASSIVE <input type="checkbox"/> MECHANICAL <input checked="" type="checkbox"/> N/A |
| | EMERGENCY LIGHTING PER NFPA 101.7.9 | |
| | FIRE ALARM SYSTEM PER NFPA 101.9.6 | |

REVISION SUMMARY #1

A. REVISED / ADDED CODE SECTIONS FROM LIFE SAFETY CODE
B. REVISED STAIR LABELS TO ALPHA CHARACTERS
C. ADDED NOTE

LEGEND

| | |
|-------------------------------------|------------------------------|
| BUILDING XXXXX | AREA DESIGNATION |
| AREA SQ. FOOTAGE: 00000000 | |
| NO. S.F./OCC. 00 S.F./OCC. | USE GROUP X-0 |
| PER CODE LOAD TO DETERMINE OCC. 000 | TOTAL OCC. LOAD PER AREA 000 |

----- 3 HOUR WALL SEPARATION
 ----- 2 HOUR RATED FIREWALL (B, R2 ONLY). ALL DOORS SHALL BE RATED TO PROVIDE A HORIZONTAL EXIT FROM THE ADJACENT BUILDING
 ----- 2 HOUR RATED FIRE PARTITION
 ----- 1 HOUR RATED FIRE PARTITION
 ----- TRAVEL DISTANCE
 ----- EXIT SEPARATION LENGTH
 ----- DIAGONAL LENGTH
 ○ FE □ FEC SURFACE/RECESSED MOUNTED FIRE EXTINGUISHER CABINET A 27" A.F.F. MAX.

KEYPLAN

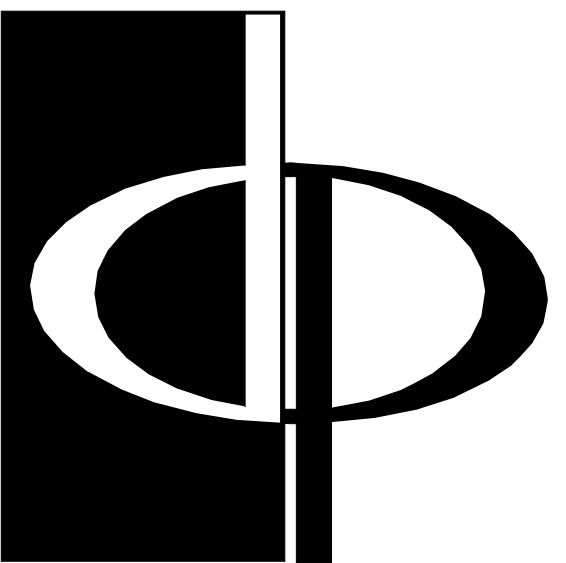

THE PRESTON PARTNERSHIP, LLC
A MULTI-DISCIPLINARY DESIGN FIRM
SOUTH TERRACES
115 PERIMETER CENTER PLACE, SUITE 950
ATLANTA, GEORGIA 30346
TELEPHONE: 770 396 7248
FAX: 770 396 2945

WWW.THEPRESTONPARTNERSHIP.COM
CONSULTANT

SEAL



PROJECT
RESERVE AT THE BALLPARK, PHASE II, AKA REVEL AT THE BALLPARK
2885 CRESCENT PKWY
SMYRNA, GA 30080

FOR



ATLANTIC REALTY PARTNERS
3438 PEACHTREE ROAD
SUITE 1425
ATLANTA, GA 30326

ISSUES & REVISIONS

| | |
|------------------------|------------|
| CONCEPTUAL DESIGN | 08/21/2015 |
| PROGRESS SET | 09/02/2015 |
| SCHEMATIC DESIGN | 09/28/2015 |
| GMP/DESIGN DEVELOPMENT | 10/15/2015 |
| FOUNDATION PACKAGE | 12/07/2015 |
| GMP | 04/03/2017 |
| PERMIT SET | 05/22/2017 |
| 1. FM COMMENTS | 07/19/2017 |
| 3. BUILDING PERMIT | 07/25/2017 |

DATE 05/22/2017
JOB NUMBER 1493101
DRAWN BY EKS/CH
CHECKED BY CWB
SHEET TITLE CODE DATA - PARKING DECK
SHEET NUMBER
COMMENTS BUILDING PERMIT RE-SUBMISSION
30X42 © 2017 The Preston Partnership, LLC