

REVISION SUMMARY #1

A. CHANGED NAME OF STAIR 1 TO STAIR A
 B. CHANGED NAME OF STAIR 1A TO STAIR B
 C. CHANGED NAME OF STAIR 2 TO STAIR C
 D. CHANGED NAME OF STAIR 3 TO STAIR D
 E. CHANGED NAME OF STAIR 4 TO STAIR E
 F. CHANGED NAME OF STAIR P1 TO STAIR F
 G. CHANGED NAME OF STAIR P2 TO STAIR G
 H. ADDED HOSE LAYOUTS TO PARKING DECK

REVISION SUMMARY #1

A. ADDED HOSE LAYOUTS TO RESIDENTIAL BUILDING

DEAD-END FIRE APPARATUS ACCESS ROAD TURNAROUND

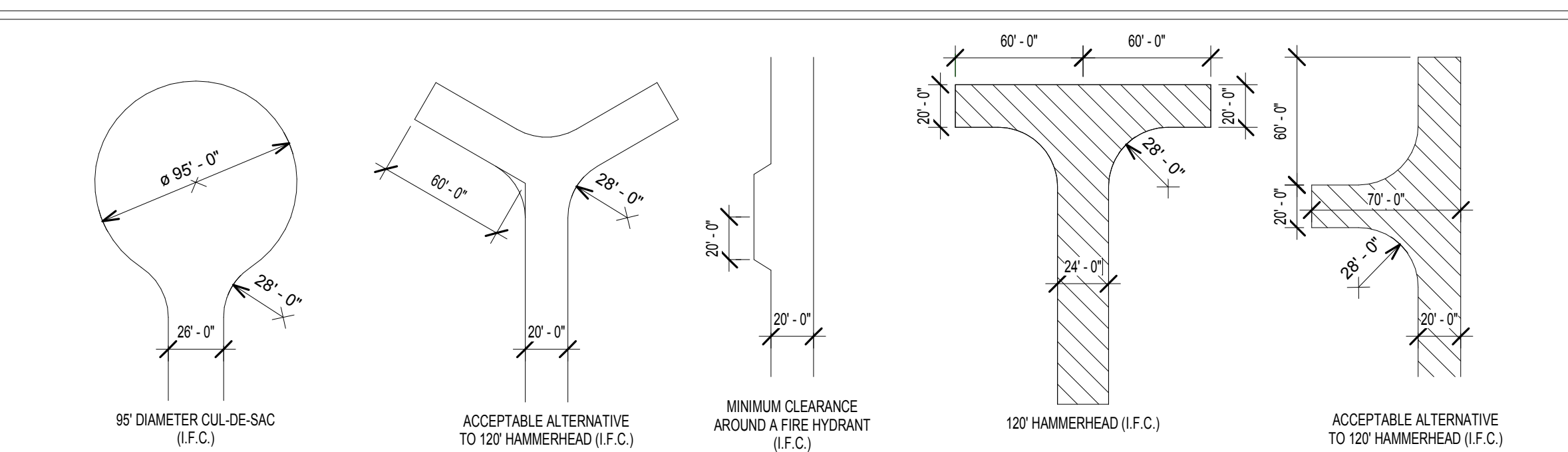

FIRE LEGEND

- ◆ FIRE DEPARTMENT CONNECTION (F.D.C.)
- ➔ FIRE DEPARTMENT PERSONNEL ACCESS POINT
- STANDPIPE LOCATION
- FIRE DEPARTMENT ACCESS ROUTE (PERSONNEL AND APPARATUS)
- ⚡ FIRE HYDRANT LOCATION
- T TRANSFORMER

FIRE HYDRANT LOCATIONS AND DISTRIBUTION

PER 2012 INTERNATIONAL FIRE CODE (I.F.C.)

PROJECT SPECIFIC REQUIREMENTS

1. WHERE REQUIRED: WHERE A PORTION OF THE FACILITY OR BUILDING IS MORE THAN 400 FT. FROM A HYDRANT ON A FIRE APPARATUS ACCESS ROAD, AS MEASURED BY AN APPROVED ROUTE AROUND THE EXTERIOR OF THE FACILITY OR BUILDING, ON-SITE FIRE HYDRANTS AND MAINS SHALL BE PROVIDED WHERE REQUIRED BY THE CODE OFFICIAL.

EXCEPTIONS:
 A. FOR GROUP R-3 AND GROUP U OCCUPANCIES, THE DIST. REQUIREMENT SHALL BE 600 FT.
 B. FOR BUILDING WITH NFPA 13 OR 13R SPRINKLERS, THE DIST. REQUIREMENT SHALL BE 600 FT.

2. CLEAR SPACE AROUND HYDRANT: MIN. 3 FT. AROUND CIRCUMFERENCE.

3. FIRE HYDRANT LOCATIONS: ALWAYS REQUIRED FIRE APPARATUS ACCESS ROADS AND ADJACENT PUBLIC STREETS.

4. MIN. NO. & DISTRIB. OF FIRE HYDRANTS PER BELOW (TABLE C105.1)

FIRE-FLOW REQUIREMENT (GPM)	MIN. NO. OF HYDRANTS	AVG. SPACING BETWEEN HYDRANTS (FT.)	MAX. DIST. FROM ANY POINT ON STREET OR ROAD FRONTAGE TO A HYDRANT
1750 OR LESS	1	500	250
2000 - 2250	2	450	225
2500	3	450	225
3000	3	400	225
3500 - 4000	4	350	210
4500 - 5000	5	300	180
5500	6	300	180
6000	6	250	150
6500 - 7000	7	250	150
7500 OR MORE	8 OR MORE	200	120

5. REDUCE BY 100 FT. FOR DEAD-END STREETS OR ROADS.

6. WHERE STREETS ARE PROVIDED WITH MEDIAN DIVIDERS WHICH CAN BE CROSSED BY FIRE FIGHTERS PULLING HOSE LINES, OR WHERE ARTERIAL STREETS ARE PROVIDED WITH FOUR OR MORE TRAFFIC LANES AND HAVE A TRAFFIC COURT OF MORE THAN 30,000 VEHICLES PER DAY, HYDRANT SPACING SHALL AVERAGE 500 FT. ON EACH SIDE OF THE STREET AND BE ARRANGED ON AN ALTERNATING BASIS UP TO A FIRE-FLOW REQUIREMENT OF 7,000 GALLONS PER MINUTE AND 400 FT. FOR HIGHER FIRE-FLOW REQUIREMENTS.

7. WHERE NEW WATER MAINS ARE EXTENDED ALONG STREETS WHERE HYDRANTS ARE NOT NEEDED FOR PROTECTION OF STRUCTURES OR SIMILAR FIRE PROBLEMS, FIRE HYDRANTS SHALL BE PROVIDED AT SPACING NOT TO EXCEED 1,000 FT. TO PROVIDE FOR TRANSPORTATION HAZARDS.

8. REDUCE BY 50 FT. FOR DEAD-END STREETS OR ROADS.

9. ONE HYDRANT FOR EACH 1,000 GALLONS PER MINUTE OR FRACTION THEREOF.

5. AVERAGE HYDRANT SPACING: NOT TO EXCEED THAT LISTED (ABOVE). EXCEPTION: PER FIRE CHIEF.

REGARDLESS OF AVG. SPACING, LOCATED SO THAT ALL POINTS ON STREETS AND ACCESS ROADS ADJACENT TO A BUILDING ARE WITHIN THE DISTANCES LISTED (ABOVE).

FIRE APPARATUS ACCESS ROAD REQUIREMENTS

PER 2012 INTERNATIONAL FIRE CODE (I.F.C.)

PROJECT SPECIFIC REQUIREMENTS

1. WHERE REQUIRED: PROVIDE FOR EVERY FACILITY, BUILDING OR PORTION OF A BUILDING ACCESS ROAD SHALL COMPLY WITH INFORMATION BELOW AND SHALL EXTEND TO WITHIN 150 FT. OF ALL PORTIONS OF THE FACILITY OR PORTION OF THE EXTERIOR WALL OF THE FIRST STORY OF THE BUILDING AS MEASURED BY APPROVED ROUTE AROUND EXTERIOR.

EXCEPTION: PER CODE OFFICIAL WHERE:
 A. SPRINKLERED NFPA 13 OR 13R
 B. ACCESS ROADS CANNOT BE INSTALLED AND APPROVED ALTERNATIVE MEANS PROVIDED.
 C. NOT MORE THAN TWO GROUP R-3 OR GROUP U OCCUPANCIES.

2. SPECIFICATIONS:
 A. DIMENSIONS: MIN. UNOBSTRUCTED 20 FT. ACCESS ROAD WIDTH & 14'-0" VERTICAL.
 B. TURNING RADIUS: 30'-0" INSIDE AND 42'-0" OUTSIDE.
 C. DEAD-ENDS: IN EXCESS OF 150 FT. PROVIDE TURNAROUND.

3. ACCESS & LOADING: DRYING SURFACE SHALL BE CAPABLE OF SUPPORTING IMPOSED LOAD OF FIRE APPARATUS WEIGHING AT LEAST 80,000 LBS.

4. ACCESS ROAD WITH A HYDRANT: MIN. 26 FT. WIDTH.

5. GRADE: ACCESS ROADS SHALL NOT EXCEED 10 PERCENT IN GRADE. EXCEPTION: STEEPER AS APPROVED BY FIRE CHIEF.

6. TURNING RADIUS: MIN. PER CODE OFFICIAL.

7. DEAD-END ACCESS ROADS: IF GREATER THAN 150 FT. MUST HAVE ACCEPTABLE WIDTH & TURNAROUND PER FOLLOWING:

LENGTH (FT.)	WIDTH (FT.)	TURNAROUNDS REQUIRED
0-150	20	NONE REQUIRED
151-500	20	120 FT. "HAMMERHEAD", 60 FT. "Y" OR 86 FT. DIAMETER CUL-DE-SAC (PER I.F.C. DIAGRAMS)
501-750	26	120 FT. "HAMMERHEAD", 60 FT. "Y" OR 86 FT. DIAMETER CUL-DE-SAC (PER I.F.C. DIAGRAMS)
OVER 750		SPECIAL APPROVAL REQUIRED

8. SIGNS: WHERE REQUIRED BY CODE OFFICIAL, MIN. DIM. OF 12" W X 18" H, POSTED PER FOLLOWING:

A. ROADS 20 FT. WIDE, BOTH SIDES POSTED.

9. COMMERCIAL AND INDUSTRIAL DEVELOPMENTS:
 A. BUILDING EXCEEDING 3 STORIES OR 30 FT. IN HT. MIN. 3 MEANS OF FIRE APPARATUS ACCESS FOR EACH STRUCTURE.
 B. BUILDING EXCEEDING 62,000 S.F. (GROSS): MIN. 2 SEPARATE AND APPROVED ACCESS ROADS.

EXCEPTION: BUILDINGS WITH APPROVED AUTOMATIC SPRINKLER SYSTEMS AND UP TO 124,000 S.F. (GROSS) - MIN. 1 APPROVED ACCESS ROAD.

C. REMOTENESS: WHERE 2 ACCESS ROADS REQUIRED: PLACED DISTANCE APART - MIN. 1/2 OVERALL DIAGONAL DIM. OF PROPERTY OR AREA SERVED.

D. PROXIMITY TO BUILDING: AT LEAST ONE OF REQUIRED ACCESS ROUTES MEETING THIS CONDITION WITHIN MIN. 15 FT. / MAX. 30 FT. FROM THE BUILDING. POSITIONED PARALLEL TO ONE ENTIRE SIDE OF THE BUILDING.

10. AERIAL FIRE APPARATUS ACCESS ROADS:

A. WHERE REQUIRED: BUILDINGS OR PORTIONS OF BUILDINGS OR FACILITIES EXCEEDING 30 FT. IN HT. ABOVE LOWEST LEVEL OF FIRE DEPARTMENT VEHICLE ACCESS.

B. OVERHEAD: UTILITY & POWER LINES NOT ALLOWED.

C. WIDTH: MIN. UNOBSTRUCTED WIDTH OF 20'-0".

D. PROXIMITY TO BUILDING: AT LEAST ONE OF REQUIRED ACCESS ROUTES MEETING THIS CONDITION WITHIN MIN. 15 FT. / MAX. 30 FT. FROM THE BUILDING. POSITIONED PARALLEL TO ONE ENTIRE SIDE OF THE BUILDING.

11. MULTIFAMILY RESIDENTIAL DEVELOPMENTS:

A. PROJECTS HAVING MORE THAN 100 DWELLING UNITS: EQUIPPED THROUGHOUT WITH 2 SEPARATE AND APPROVED ACCESS ROADS.

EXCEPTION: PROJECTS EQUIPPED THROUGHOUT WITH APPROVED AUTOMATIC SPRINKLER SYSTEMS AND HAVING UP TO 200 DWELLING UNITS = 1 MIN. APPROVED ACCESS ROAD.

B. PROJECTS HAVING MORE THAN 200 DWELLING UNITS: MIN. 2 SEPARATE AND APPROVED ACCESS ROADS (REGARDLESS OF SPRINKLERING).

NOTE:
 1. AREA SEPARATION WALLS TO BE HEBEL BLOCK, AERATED AUTOGRAVED CONCRETE BLOCK.
 2. SEE "100" SHEETS FOR TRAVEL DISTANCES WITHIN UNITS AND TOTAL TRAVEL DISTANCES IN CORRIDORS TO EXITS.
 3. SEE CIVIL FOR ALL FIRE HYDRANT RELOCATIONS AND/OR NEW LOCATIONS.
 4. ALL FIRE WALLS TO BE 3-HOUR RATED PER IBC 706.4

1 FIRE APPARATUS PLAN

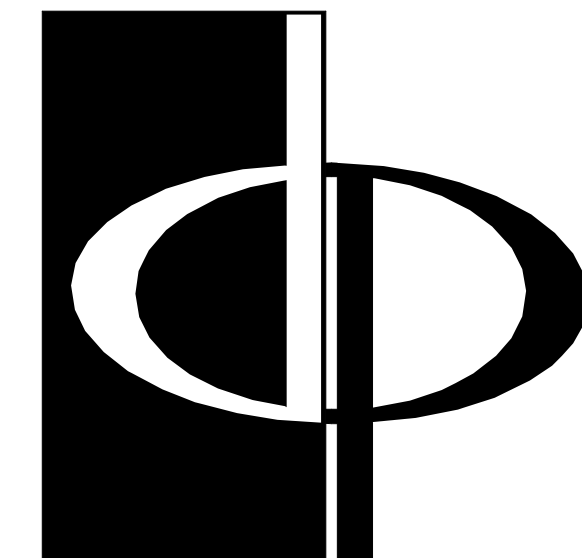
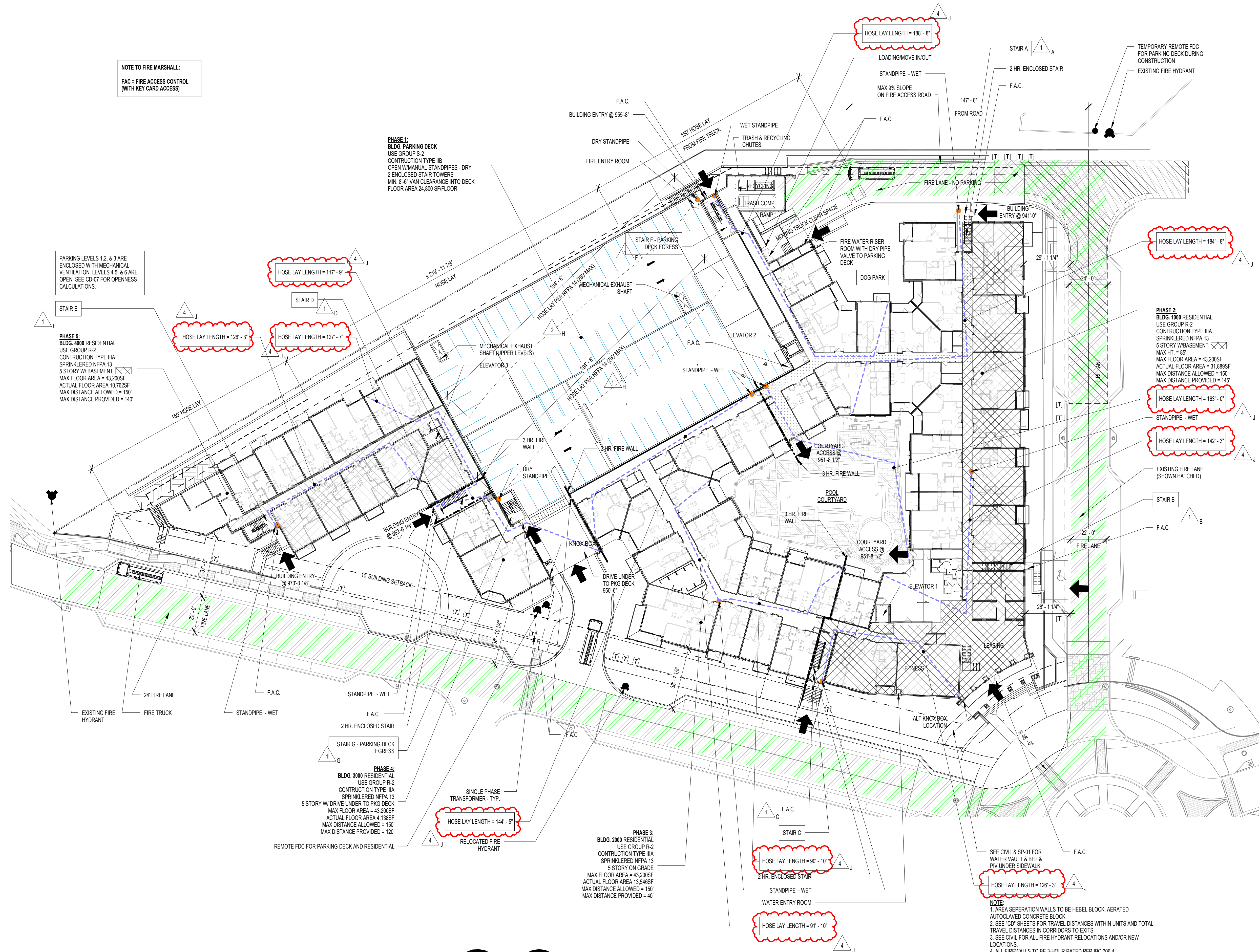
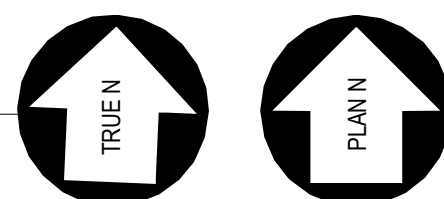
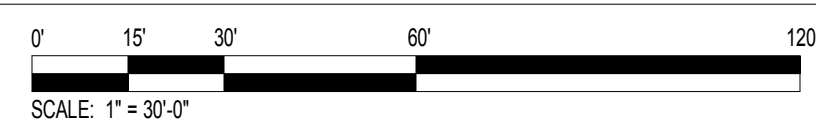

**THE PRESTON
PARTNERSHIP, LLC**
 A MULTI-DISCIPLINARY DESIGN FIRM

SOUTH TERRACES
 115 PERIMETER CENTER PLACE, SUITE 950
 ATLANTA, GEORGIA 30346
 TELEPHONE: 770 396 7248
 FAX: 770 396 2945

WWW.THEPRESTONPARTNERSHIP.COM

CONSULTANT

SEAL



PROJECT

**RESERVE AT THE
BALLPARK, PHASE II,
AKA REVEL AT THE
BALLPARK**
 2885 CRESCENT PKWY
 SMYRNA, GA 30080

FOR



**ATLANTIC REALTY
PARTNERS**

3438 PEACHTREE ROAD
 SUITE 1425
 ATLANTA, GA 30326

ISSUES & REVISIONS

CONCEPTUAL DESIGN	08/21/2015
SCHEMATIC DESIGN	09/28/2015
CM/CD DESIGN DEVELOPMENT	10/15/2015
GMP	04/03/2017
PERMIT SET	05/22/2017
1. FM COMMENTS	07/19/2017
3. BUILDING PERMIT	07/25/2017
4. FM COMMENTS #2	08/11/2017

DATE **05/22/2017**

JOB NUMBER **1493101**

DRAWN BY **EKS/NB**

CHECKED BY **CW**

SHEET TITLE **FIRE APPARATUS PLAN**

SHEET NUMBER

FA-01

COMMENTS **BUILDING PERMIT RE-SUBMISSION**

30X42 © 2017 The Preston Partnership, LLC