

REVEL AT THE BALLPARK

A Development By
ATLANTIC REALTY PARTNERS, INC.

LAND LOT 877, 916, & 917 OF THE 17-TH DISTRICT
COBB COUNTY, GEORGIA

DEVELOPMENT REFERENCE

OWNER/DEVELOPER: ATLANTIC REALTY PARTNERS, INC.
3378 PEACHTREE RD.
ATLANTA, GA 30326
PHONE: (404) 591-2492

ARCHITECT: THE PRESTON PARTNERSHIP, LLC
SOUTH TERRACES 115 PERIMETER CENTER
PLACE., SUITE 950
ATLANTA, GA 30346
PHONE: (770) 396-7248

CIVIL ENGINEER: KIMLEY-HORN
10 ROSWELL STREET
SUITE 210
ALPHARETTA, GEORGIA 30009
PHONE: (770) 619-4280

LANDSCAPE ARCHITECT: SGN+A
315 W. PONCE DE LEON AVE. SUITE 755
DECATUR, GA 30030
PHONE: (404) 373-7370

Cobb County does not certify the accuracy of these plans. Approval by the County is based on its reliance on the information and representations submitted by the licensed professional whose name and seal appear on these plans. Cobb County assumes no liability or responsibility for the accuracy of the representations shown hereon.

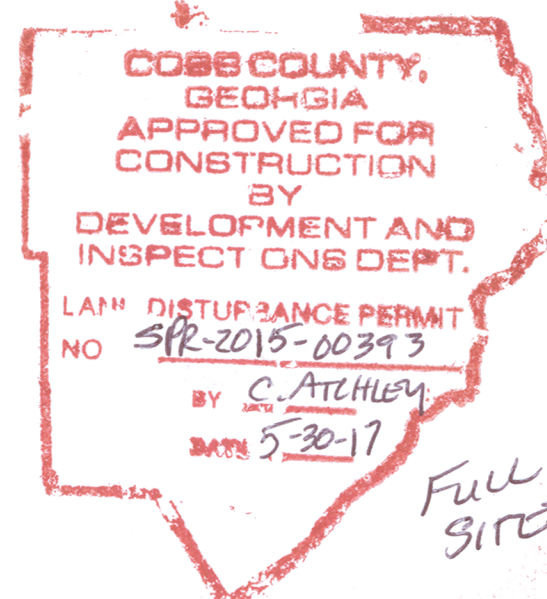

TREE / LANDSCAPE PLAN APPROVAL

This plan is in compliance with all tree preservation and/or landscaping requirements of the Cobb County Code. If any changes must be made due to plant availability, site conditions or other reasons, a new plan must be submitted to the Community Development Site Plan Review Section for review and approval before the changes are implemented. Failure to obtain the necessary plan approval will result in a delay in the final project approval.

C. Archley 5-30-17
Architect / Landscape Architect Date

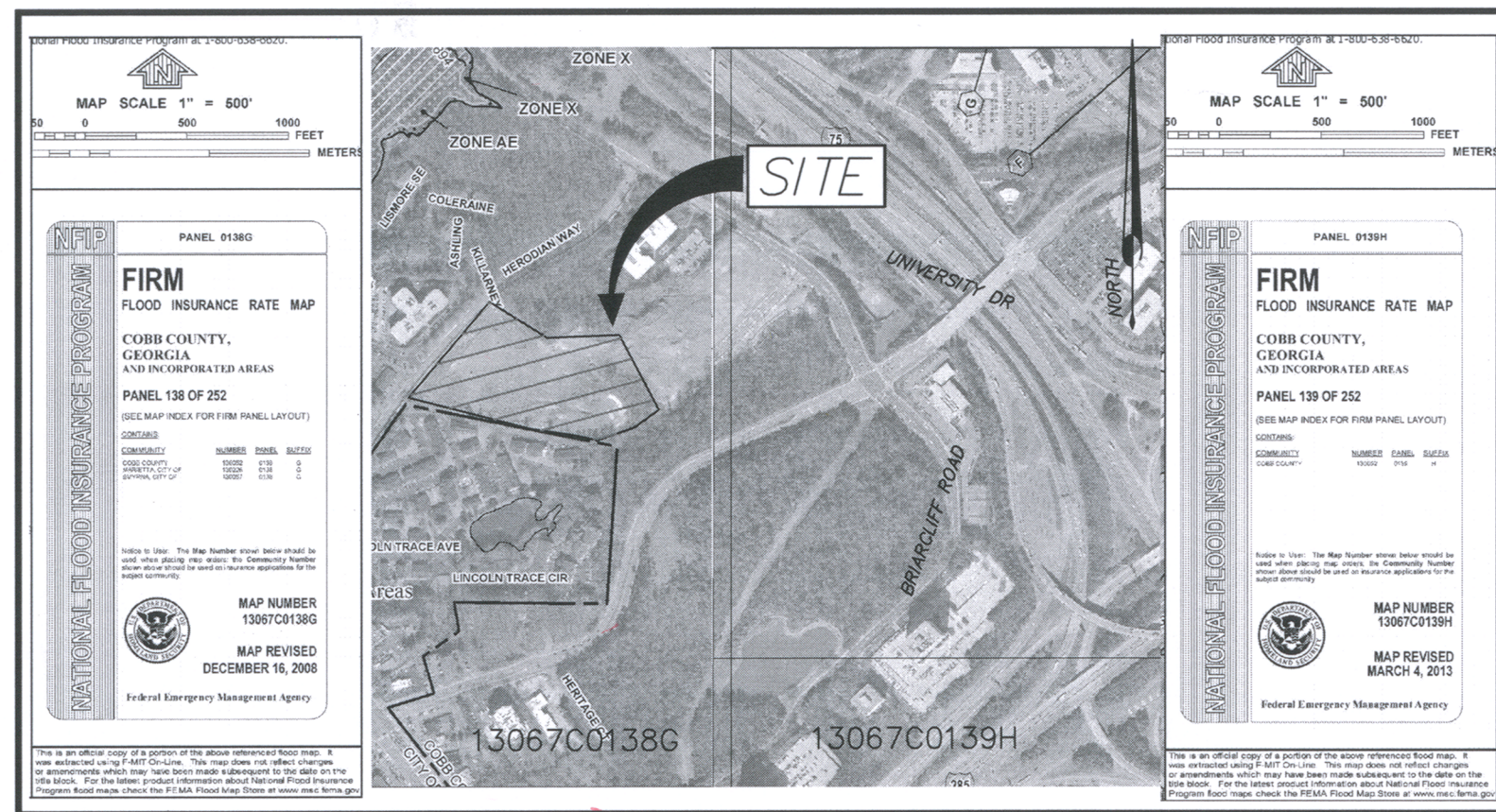
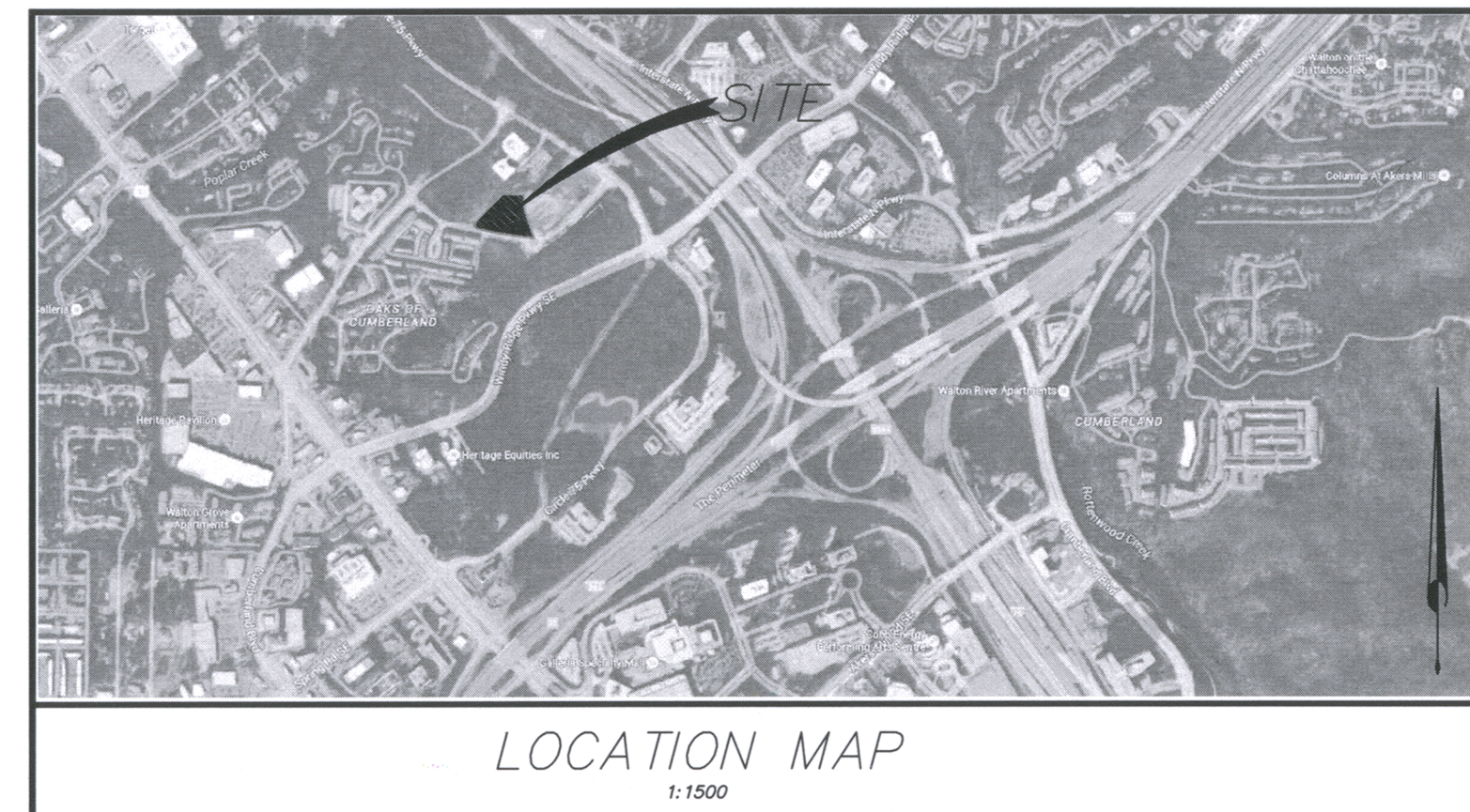

SITE DATA:
TOTAL SITE AREA = 3.40 AC
DISTURBED AREA = 3.60± AC.
0.2 AC. OF ADJACENT PROPERTY ON NORTH SIDE OF THE PROJECT WILL BE TEMPORARILY DISTURBED DURING PARKING DECK AND RETAINING WALL CONSTRUCTION. THE GRADE WILL BE BROUGHT BACK TO EXISTING CONDITIONS AND REPLANTED. SEE TREE REPLACEMENT PLAN FOR DETAILS.

A PRE-CONSTRUCTION LANDSCAPE CONFERENCE IS REQUIRED FOR THIS PROJECT. CALL THE COBB COUNTY ARBORIST AT (770) 528-2124 OR LANDSCAPE ARCHITECT AT (770) 528-2149. THERE ARE CRITICAL FACTORS ON THE LANDSCAPE PLAN THAT AFFECT BOTH THE GENERAL CONTRACTOR AND THE LANDSCAPE CONTRACTOR. PLANTING AREA DIMENSIONS, PLANTING METHODS AND AS WELL AS PLANT MATERIALS MUST BE IN ACCORDANCE WITH THE APPROVED PLAN, OR THE LANDSCAPE INSPECTOR MAY DELAY THE RELEASE OF THE CERTIFICATE OF OCCUPANCY.

EROSION CONTROL AND TREE PROTECTION MEASURES SHALL BE INSTALLED PRIOR ANY OTHER CONSTRUCTION ACTIVITY AND MAINTAINED UNTIL PERMANENT GROUND COVER IS ESTABLISHED

Sheet List Table

Sheet Number	Sheet Title
C0-00	COVER SHEET
C0-01	GENERAL NOTES
C0-10	ZONING CONDITIONS (SHEET 1 OF 5)
C0-11	ZONING CONDITIONS (SHEET 2 OF 5)
C0-12	ZONING CONDITIONS (SHEET 3 OF 5)
C0-13	ZONING CONDITIONS (SHEET 4 OF 5)
C0-14	ZONING CONDITIONS (SHEET 5 OF 5)
C0-15	ZONING SITE PLAN
-	SURVEY
C1-50	DEMOLITION PLAN
C2-00	SITE PLAN
C2-10	FIRE ACCESS PLAN
C3-00	GRADING PLAN
C3-01	DETAIL GRADING & DRAINAGE PLAN
C3-10	DRAINAGE PLAN
C3-50	STORM PROFILES
C3-51	STORM PROFILES
C4-00	UTILITY PLAN
C4-10	DETAILED UTILITY PLAN
C4-50	SANITARY SEWER PROFILES
C5-00	EROSION CONTROL NOTES
C5-01	EROSION CONTROL NOTES
C5-02	EROSION CONTROL NOTES
C5-03	EROSION CONTROL NOTES
C5-10	EROSION CONTROL PLAN - PHASE I
C5-20	EROSION CONTROL PLAN - PHASE II
C5-30	EROSION CONTROL PLAN - PHASE III
C5-80	EROSION CONTROL DETAILS
C5-81	EROSION CONTROL DETAILS
C6-00	CONSTRUCTION DETAILS-SEWER
C6-01	CONSTRUCTION DETAILS-STORM
C6-02	CONSTRUCTION DETAILS-STORM
C6-03	CONSTRUCTION DETAILS-WATER
C6-04	CONSTRUCTION DETAILS

DRAWINGS BY OTHERS:

Sheet List Table

Sheet Number	Sheet Title
L-1	TREE PROTECTION PLAN
L-2	TREE PROTECTION PLAN

NO STREET PARKING HAS BEEN APPROVED FOR THIS DEVELOPMENT OTHER THAN IN DELINEATED SPACES

MINIMUM ISD REQUIREMENTS MUST BE SATISFIED PRIOR TO START OF CLEARING OPERATIONS.

ANY CONSTRUCTION TRAILERS TO BE PERMITTED THROUGH THE ZONING DIVISION

THE COBB COUNTY CEMETERY PRESERVATION COMMISSION RESERVES THE RIGHT TO EXAMINE THIS PROPERTY FOR ETHNIC, CULTURAL AND RELIGIOUS EVIDENCE LOCATED THEREIN. IF ANY ETHNIC, CULTURAL OR RELIGIOUS EVIDENCE IS FOUND DURING DEVELOPMENT, THEN THE COBB COUNTY CEMETERY PRESERVATION COMMISSION MUST BE NOTIFIED AT ONCE AT 770-528-2035. FAILURE TO DO SO WILL RESULT IN A STOP-WORK ORDER.

24 HOUR CONTACT:
BEN CURRAN
(404) 591-2492

GEORGIA811
Know what's below.
Call before you dig.

Kimley»Horn
© 2015 KIMLEY-HORN AND ASSOCIATES, INC.
10 ROSWELL STREET, SUITE 210
ALPHARETTA, GEORGIA 30009
PHONE (770) 619-4280
WWW.KIMLEY-HORN.COM

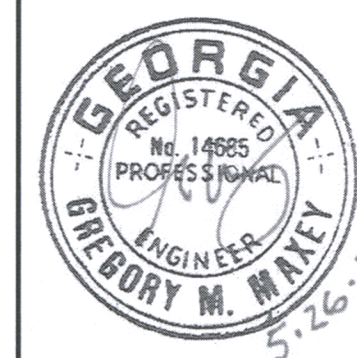

CLIENT: ATLANTIC REALTY PARTNERS, INC.

PROJECT: REVEL AT THE BALLPARK II
COBB COUNTY, GA

TITLE: COVER SHEET

DATE: 11/04/2015
PROJECT NO.: 018459002
SHEET NUMBER: C0-00

REVISIONS	No.	DATE	BY
	7		
	6		
	5		
	4	05/26/2017	SD
	3	04/03/2017	SD
	2	02/16/2016	SD
	1	11/04/2015	SD