



## Revisions:

Date: Description:

12/07/15 County Comments

05/19/17 Owner Comments

Landscape  
DocumentsRevel at the  
Ballpark

Cobb County, Georgia

A Residential Development by

Atlantic Realty Partners

This drawing as an instrument of  
services, is and shall remain the  
property of SGN+A and shall not  
be reproduced, published or used  
in any way without permission of  
SGN+A, Inc.

Sheet Title:  
Tree Replacement  
Plan

Date: 11/05/2015

Sheet Number:

L-1

Not Released for Construction

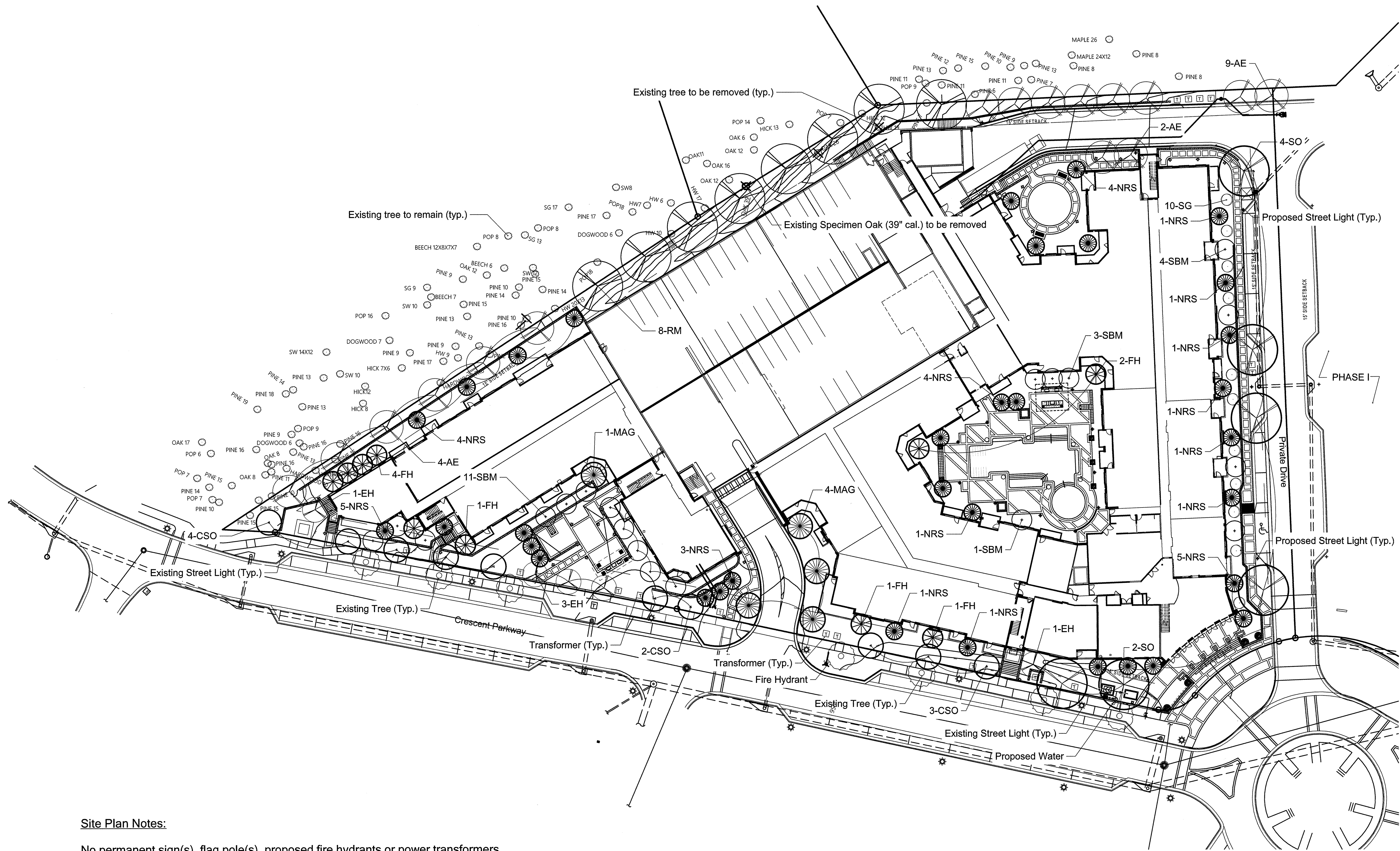

## Site Plan Notes:

No permanent sign(s), flag pole(s), proposed fire hydrants or power transformers will be placed in conflict with an ordinance coded or approved tree planting location.

The Cobb County Arborist or Landscape Architect must approve the site lighting plan. Light poles are not permitted in parking peninsulas, islands and medians without the prior approval of the County Arborist. 20' minimum spacing is required between the trunk of any proposed over-story hardwood tree (or existing tree counted for tree ordinance credit) and any existing or proposed light pole. If the service provider (electric company) produces a lighting plan, it must adhere to the lighting plan shown in the civil engineering drawings approved by Cobb County for the land disturbance permit. If a lighting plan is not part of the civil drawings, the lighting plan designer must submit a plan to the Arborist/Landscape Architect for review and approval. If site lighting is installed without an approved plan, the Certificate of Occupancy will be withheld until all conflicting power poles are moved. Call 770-528-2124.

The site contractor shall coordinate service routing of all gas, telephone and electrical lines with the appropriate utility company. All construction must comply with each utility's standards and specifications and not interfere with tree planting sites or existing trees to be preserved.

## Replacement Trees

Plan Name	Botanical Name	Minimum Size	QTY.	RDF Units Per Tree	Total RDF	% RDF Units
AE	Allee Elm	5" cal.	16	0.9	14.4	16.1
CSO	Columnar Spire Oak	5" cal.	10	0.9	9.0	10.1
FH	Foster Holly	10' ht.	10	0.6	6.0	6.8
EH	European Hornbeam	5" cal.	5	0.9	4.5	5.0
MAG	Magnolia	10' ht.	5	0.6	3.0	3.2
NRS	Nellie R. Stevens Holly	10' ht.	35	0.6	21.0	23.3
RM	Red Maple	5" cal.	8	0.9	7.2	8.0
SBM	Sweet Bay Magnolia	10' ht.	19	0.5	9.5	10.5
SG	Sweet Gum	5" cal.	11	0.9	9.9	11.1
SO	Shumard Oak	5" cal.	6	0.9	5.4	6.0
			118		89.9	

0 30 60 120  
Scale: 1"= 30'