

THE PRESTON
PARTNERSHIP, LLC
A MULTI-DISCIPLINARY DESIGN FIRM

SOUTH TERRACES
115 PERIMETER CENTER PLACE, SUITE 950
ATLANTA, GEORGIA 30346
TELEPHONE: 770.396.7248
FAX: 770.396.2945
WWW.THEPRESTONPARTNERSHIP.COM

CONSULTANT

DEI
DESIGN
ENVIRONMENTS
INC.

SEAL _____

PROJECT _____

CIRCLE 75
PHASE II

CIRCLE 75
COBB COUNTY, GA 30339

FOR _____

ATLANTIC REALTY
PARTNERS

3438 PEACHTREE ROAD
SUITE 1425
ATLANTA, GA 30326

△ ISSUE	DATE
XXXXXXXX	00.00.00
XXXXXXXX	00.00.00

DATE 07.20.16

JOB NUMBER 15303

DRAWN BY KD, MS

CHECKED BY MG

DEI JOB #

15303

SHEET TITLE

DOG SPA REFLECTED
CEILING PLAN

SHEET NUMBER

ID.203

COMMENTS _____

© 2015 The Preston Partnership, LLC

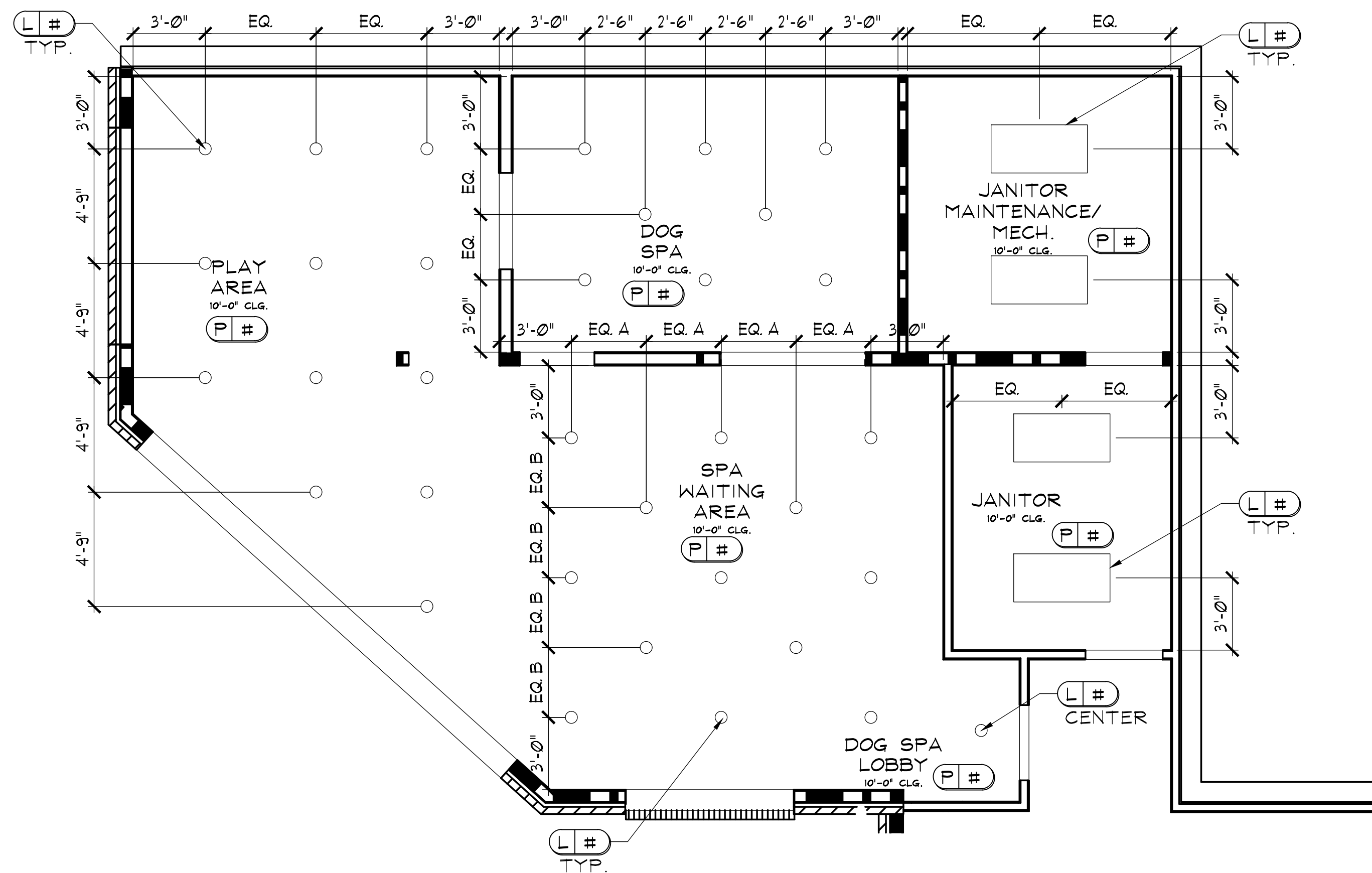

REFLECTED CEILING NOTE:

LIGHTING LOCATIONS PER ARCH UNLESS
OTHERWISE NOTED

REFLECTED CEILING KEY:

○ RECESSED CAN

□ 2'-0"X4'-0" FLUORESCENT LIGHT

ELECTRICAL NOTES:

ELECTRICAL OUTLET, JUNCTION BOX,
AND LIGHTING MUST BE REFERRED TO
AND CONFIRMED WITH ELECTRICAL
ENGINEER'S DRAWINGS AS WELL AS
STATE REQUIREMENTS. LOCATIONS AS
SHOWN ARE DESIRABLE IN ACCORDANCE
WITH DESIGN. REFER TO ELECTRICAL
ENGINEER'S DRAWING FOR ELECTRICAL
INFORMATION

1 DOG SPA REFLECTED CEILING PLAN
ID203 SCALE : 1/4" = 1'-0"