

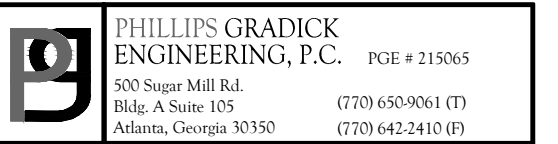

SOUTH TERRACES
5 PERIMETER CENTER PLACE, SUITE 950
ATLANTA, GEORGIA 30346
TELEPHONE: 770 396 7248
FAX: 770 396 2945

WWW.THEPRESTONPARTNERSHIP.COM
CONSULTANT



This drawing, as an instrument of service is and shall remain the property of the drafter, Gradiak Engineering, P.C., and shall not be reproduced, published or used in any way without the permission of Phillips Gradiak Engineering, P.C. This Drawing is copyrighted and protected under section 120 of the U.S. Copyright Act USC. The protection includes but is not limited to design and construction techniques. Unauthorized use of these plans without the express written permission of Phillips Gradiak Engineering, P.C. is prohibited.



PROJECT _____

REVEL AT THE BALLPARK PHASE II

885 CRESCENT PKWY
SMYRNA, GA 30080

OR _____



ATLANTIC REALTY
PARTNERS

438 PEACHTREE ROAD
SUITE 1425
ATLANTA, GA 30326

SUES & \triangle - REVISIONS _____ DATE _____

CONCEPTUAL DESIGN	8/21/15
SD PROGRESS SET	09/28/15
SMP PRICING SET	10/14/15
FOUNDATION PACKAGE	12/07/15
SMP PACKAGE	04/03/17
PERMIT SET	05/22/17

DATE 05/22/2017

1493101

DRAWN BY _____ LD

CHECKED BY _____ CMG

SHEET TITLE _____

BUILDING 4000 PROJECT -

LEVEL 3

SHEET NUMBER _____

M1 43

MI-43

© 2017 The Preston Partnership, LL

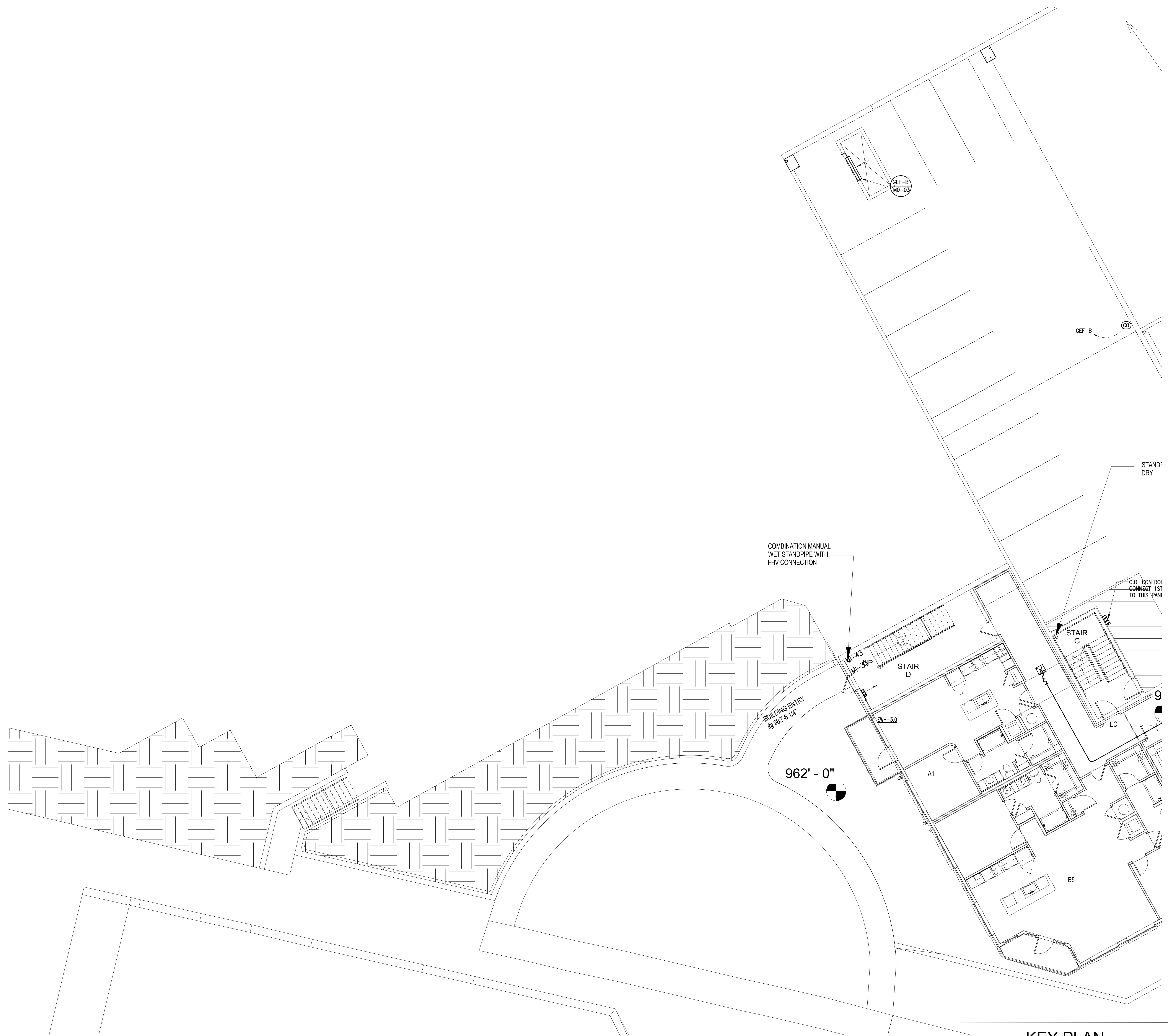

KEY PLAN

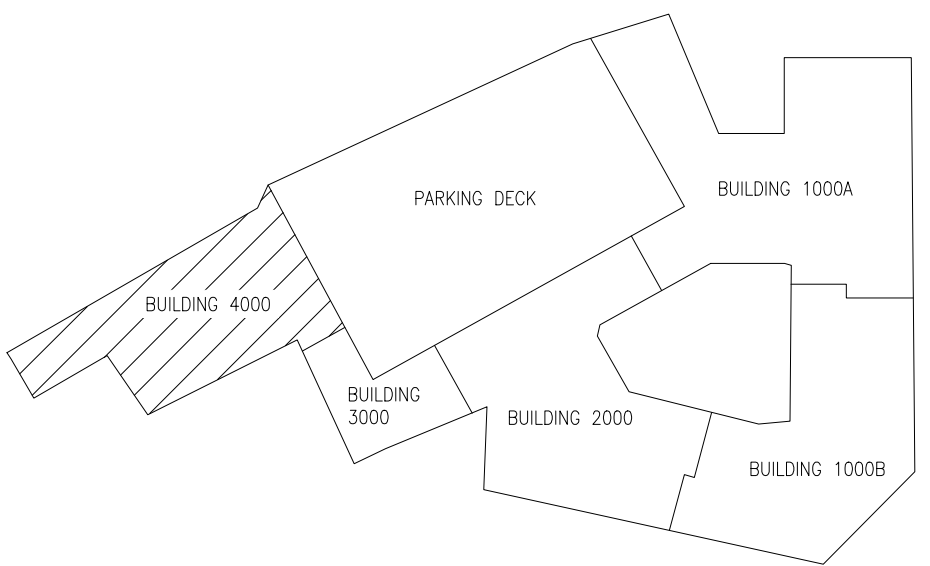

1 BUILDING 4000 PROJECT LEVEL 3
SCALE: 1/8" = 1'-0"

SCALE: 1/8" = 1'-0"

NOTES

1. SEE SHEET M.3.XX FOR APERTMENT HVAC.
2. UNLESS NOTED OTHERWISE, ALL CEILINGS ARE PART OF A RATED FLOOR/CEILING ASSEMBLY, AND REQUIRE A CEILING RADIATION DAMPER (CRD) AT EACH PENETRATION OF CEILING.
3. FOR MECHANICAL SYSTEMS SERVING THE CORRIDORS, THE O.A. INTAKE LOUVER SHALL BE INSTALLED A MINIMUM OF 10'-0" FROM THE APERTMENT UNIT EXHAUST, AVOID TERMINATION POINT OF EXHAUST DUCTS AS NECESSARY FOR EACH APERTMENT UNIT.
4. ALTERNATE ROUTING OF DRYER AND TOILET EXHAUST DUCT IN APERTMENT UNITS SHOWN HERE, TO AVOID CONFLICT WITH 10'-0" CLEARANCE REQUIREMENT FROM CORRIDOR OUTDOOR AIR INTAKE.
5. APERTMENT UNIT WINDOWS OPEN SO THAT THE TOP OF OPENING IS AT LEAST 4'-0" A.F.F. EXHAUST TERMINI SHALL BE LOCATED ABOVE THE CEILING OF APERTMENT WHICH IS LOCATED AT 9'-0" A.F.F. THIS CREATES A MINIMUM 4'-0" CLASH FROM BUILDING OPENING TO A VENT CAP.

KEY NOTES

- ① TOILET EXHAUST OUTLET.
- ② DRYER EXHAUST VENT OUTLET.
- ③ O.A. INTAKE INLET. MAINTAIN 10'-0" FROM ANY EXHAUST OUTLET AS SHOWN ON THESE PLANS.