

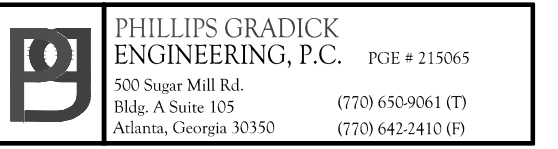

SOUTH TERRACES
5 PERIMETER CENTER PLACE, SUITE 950
ATLANTA, GEORGIA 30346
TELEPHONE: 770 396 7248
FAX: 770 396 2945

WWW.THEPRESTONPARTNERSHIP.COM
CONSULTANT



This drawing, as an instrument of service to and shall remain the property of the Phillips Cradick Engineering, P.C. and shall not be reproduced, published or used in any way without the permission of Phillips Cradick Engineering, P.C. This Drawing is copyrighted and protected under section 120 of the U.S. Copyright Act USC. The protection includes but is not limited to design and construction techniques. Unauthorized use of these plans without the express written permission of Phillips Cradick Engineering, P.C. is prohibited.

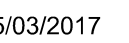

PROJECT _____

REVEL AT THE BALLPARK PHASE II

885 CRESCENT PKWY
SMYRNA, GA 30080

OR _____



ATLANTIC REALTY
PARTNERS

438 PEACHTREE ROAD
SUITE 1425
ATLANTA, GA 30326

SUES & - REVISIONS _____ DATE _____

CONCEPTUAL DESIGN	8/21/15
50% PROGRESS SET	09/28/15
100% PRICING SET	10/14/15
FOUNDATION PACKAGE	12/07/15
100% PACKAGE	04/03/17
PERMIT SET	05/22/17
REV #2 GENERAL COORDINATION	07/25/17

DATE 05/22/2017

1493101

DRAWN BY WJM

CHECKED BY _____ CDF
SHEET TITLE _____

BUILDING 1000B PLAN -
PROJECT LEVEL 1

SHEET NUMBER _____

P1-11B

COMMENTS _____

© 2017 The Preston Partnership, LL

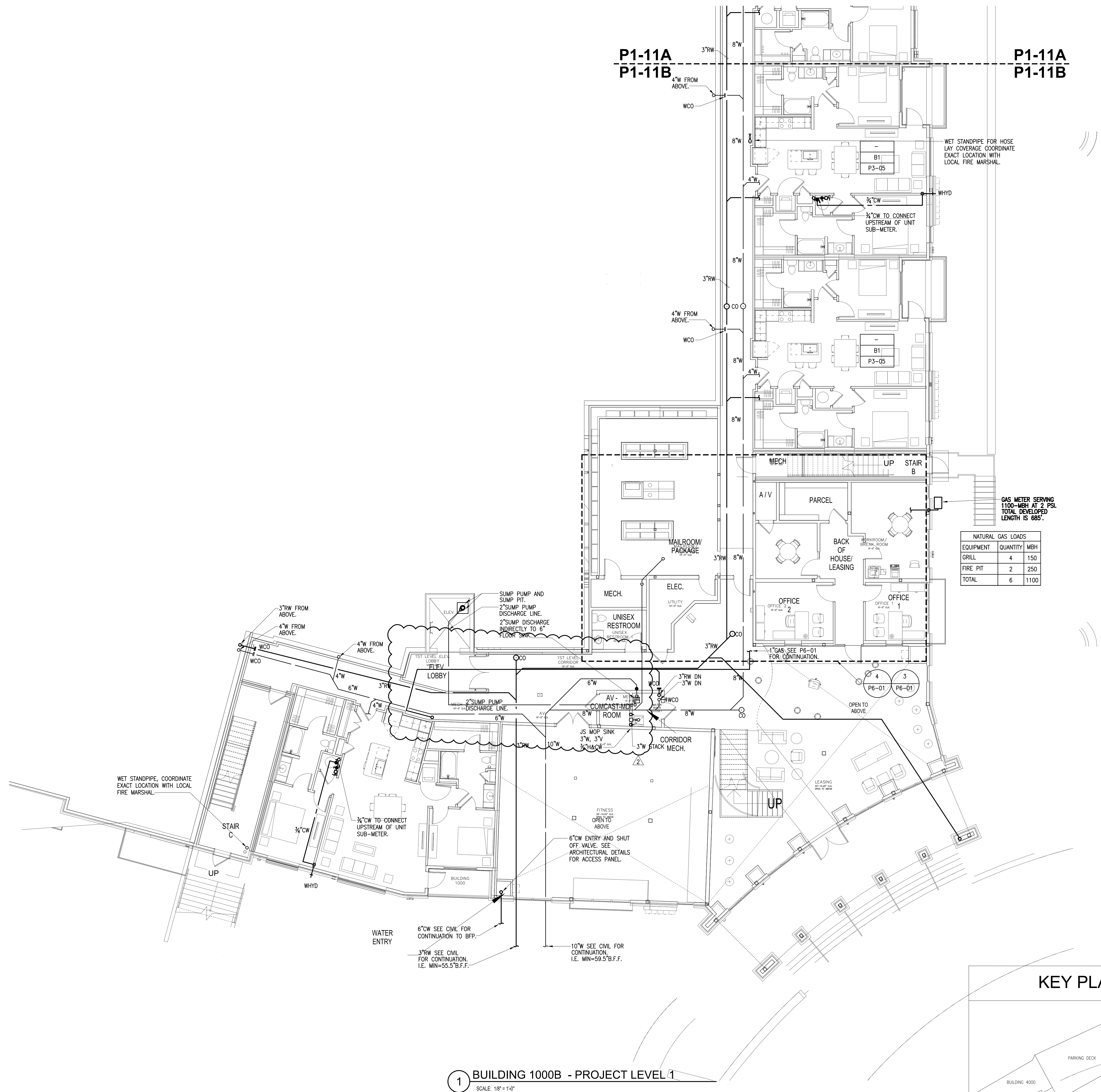

1/10/2015 4:50:43 PM V:\215065 - Circle 75 Phase II\REVIT\ver2014\LINKS\ARCH\2015-1-10\1493101 - Circle 75 II R14-Central.rvt