

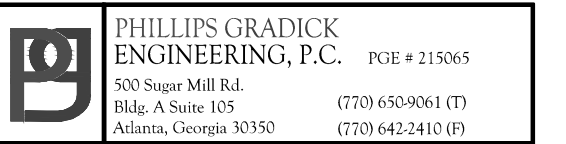

SOUTH TERRACES  
5 PERIMETER CENTER PLACE, SUITE 950  
ATLANTA, GEORGIA 30346  
TELEPHONE: 770 396 7248  
FAX: 770 396 2945

WWW.THEPRESTONPARTNERSHIP.COM  
CONSULTANT



This drawing, as an instrument of service is and shall remain the property of the Phillips Grackel Engineering, P.C. and shall not be reproduced, published or used in any way without the permission of Phillips Grackel Engineering, P.C. This Drawing is copyrighted and protected under section 120 of the U.S. Copyright Act USCC. The protection includes but is not limited to design and construction techniques. Unauthorized use of these plans without the express written permission of Phillips Grackel Engineering, P.C. is prohibited.

---



05/03/2017

## REVEL AT THE BALLPARK PHASE II

885 CRESCENT PKWY  
SMYRNA, GA 30080

OR \_\_\_\_\_



ATLANTIC REALTY  
PARTNERS

438 PEACHTREE ROAD  
SUITE 1425  
ATLANTA, GA 30326

SUES &  - REVISIONS \_\_\_\_\_ DATE \_\_\_\_\_

CONCEPTUAL DESIGN	8/21/15
SD PROGRESS SET	09/28/15
SMP PRICING SET	10/14/15
FOUNDATION PACKAGE	12/07/15
SMP PACKAGE	04/03/17
PERMIT SET	05/22/17

DATE 05/22/2017

08 NUMBER 1493101

DRAWN BY \_\_\_\_\_ WJM  
CHECKED BY \_\_\_\_\_

CHECKED BY \_\_\_\_\_ CDF

SHEET TITLE \_\_\_\_\_

BUILDING 1000A PLAN -  
PROJECT LEVEL 5

SHEET NUMBER \_\_\_\_\_

**P1-15A**

COMMENTS \_\_\_\_\_

© 2017 The Preston Partnership, LLC

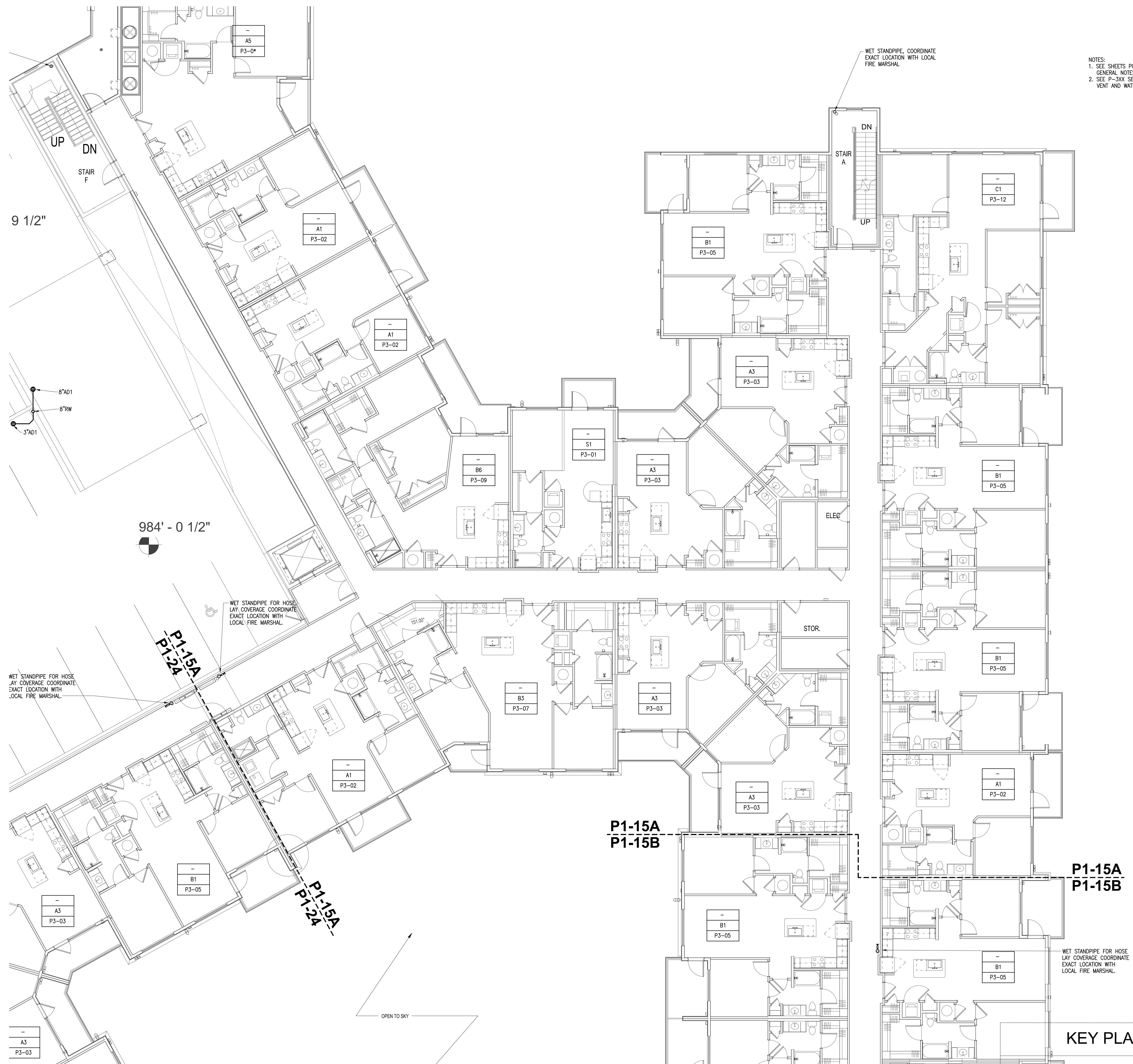

## KEY PLAN

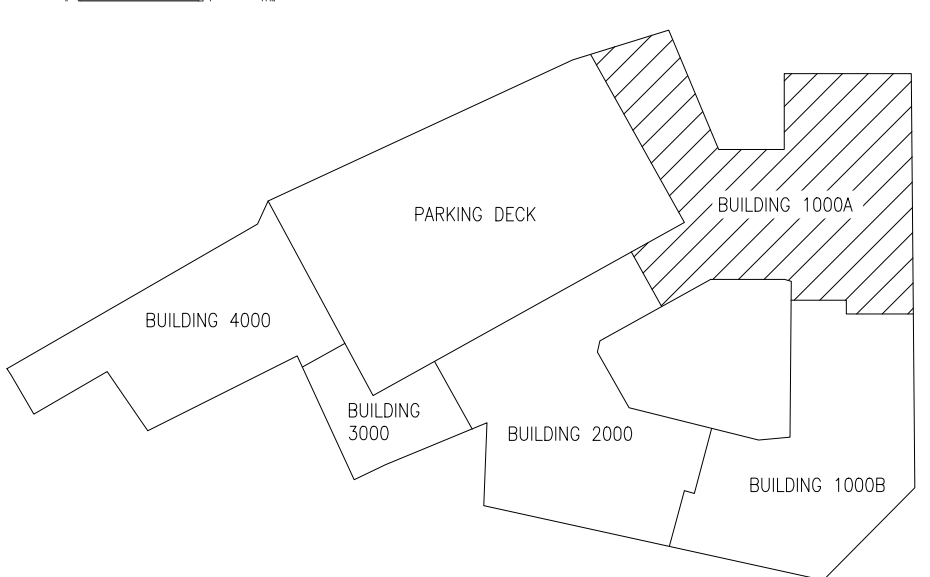

1 BUILDING 1000A - PROJECT LEVEL 5  
SCALE: 1/8" = 1'-0"

SCALE: 1/8" = 1'-0"

V:\215065 - Circle 75 Phase II\REVIT\ver2014\LINKS\ARCH2015-11-10\1493101 - Circle 75 II\_R14-Central.vrt

11/10/2015 4:50:43 PM