

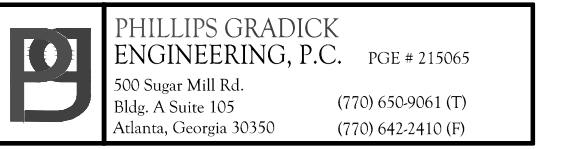

SOUTH TERRACES
5 PERIMETER CENTER PLACE, SUITE 950
ATLANTA, GEORGIA 30346
TELEPHONE: 770 396 7248
FAX: 770 396 2945

WWW.THEPRESTONPARTNERSHIP.COM
CONSULTANT



This drawing is an instrument of service and shall remain the property of the Phillips Grackel Engineering, P.C. and shall not be reproduced, published or used in any way without the permission of Phillips Grackel Engineering, P.C. This Drawing is copyrighted and material under section 120 of the U.S. Copyright Act USCC. The protection includes but is not limited to design and construction techniques. Unauthorized use of these plans without the express written permission of Phillips Grackel Engineering, P.C. is prohibited.

_____EAL

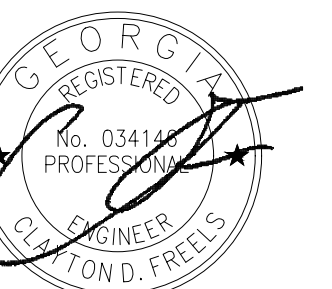

05/03/2017

PROJECT _____

REVEL AT THE BALLPARK PHASE II

885 CRESCENT PKWY
SMYRNA, GA 30080

OR _____



ATLANTIC REALTY
PARTNERS

438 PEACHTREE ROAD
SUITE 1425
ATLANTA, GA 30326

SUES & - REVISIONS _____ DATE _____

CONCEPTUAL DESIGN	8/21/15
50% PROGRESS SET	09/28/15
100% PRICING SET	10/14/15
FOUNDATION PACKAGE	12/07/15
50% PACKAGE	04/03/17
PERMIT SET	05/22/17

DATE 05/22/2017

DB NUMBER 1493101

RAWN BY _____ WJM

CHECKED BY _____ CDF

HEET TITLE BUILDING 2000 PLAN

BUILDING 2000 PLAN -
PROJECT LEVEL 6

SHEET NUMBER _____

P1-25

COMMENTS _____

© 2017 The Preston Partnership, LLC

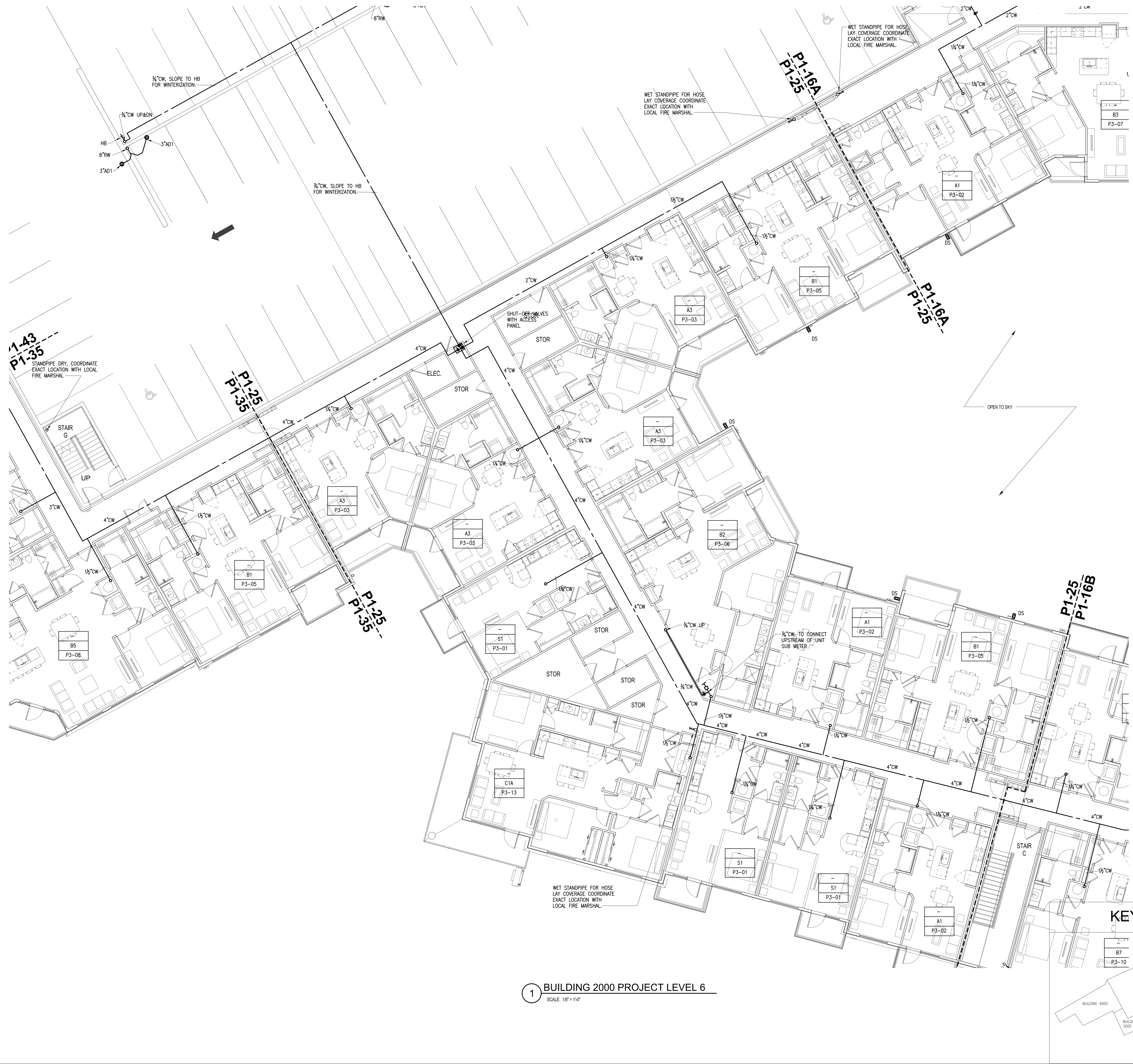

1 BUILDING 2000 PROJECT LEVEL 6
SCALE: 1/8" = 1'-0"

V:215065 - Circle 75 Phase II/REVT ver2014/LINKS/ARCH2015-11-10/1493101 - Circle 75 II_R14-Central.nt
11/10/2015 4:50:43 PM

11/10/2015 4:50:43 PM