

NOTES:  
1. SEE SHEETS P0-01, P0-02 AND P0-03 FOR GENERAL NOTES, SCHEDULES AND DETAILS.  
2. SEE P-3XX SERIES FOR UNIT PLAN WASTE, VENT AND WATER PIPING.

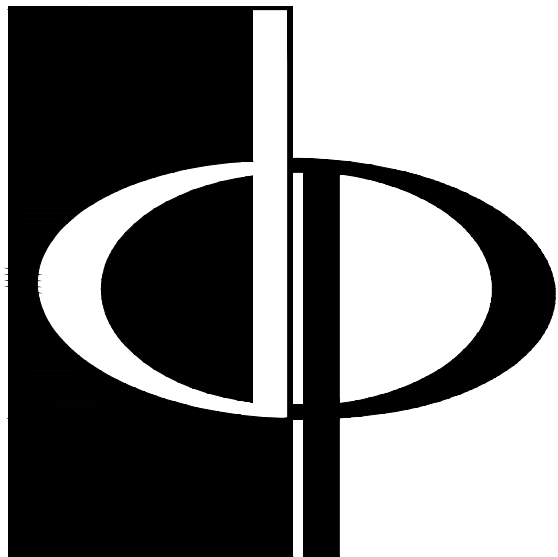

THE PRESTON  
PARTNERSHIP, LLC  
A MULTI-DISCIPLINARY DESIGN FIRM

SOUTH TERRACES  
115 PERIMETER CENTER PLACE, SUITE 950  
ATLANTA, GEORGIA 30346  
TELEPHONE: 770.396.7248  
FAX: 770.396.2945

WWW.THEPRESTONPARTNERSHIP.COM  
CONSULTANT

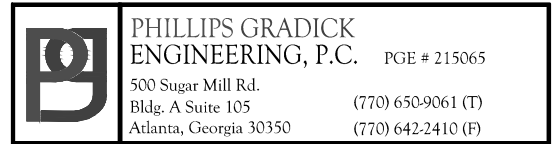

SEAL



05/03/2017  
PROJECT

REVEL AT THE  
BALLPARK  
PHASE II  
2885 CRESCENT PKWY  
SMYRNA, GA 30080

FOR



ATLANTIC REALTY  
PARTNERS

3438 PEACHTREE ROAD  
SUITE 1425  
ATLANTA, GA 30326

ISSUES & REVISIONS

| ISSUES & REVISIONS | DATE     |
|--------------------|----------|
| CONCEPTUAL DESIGN  | 8/21/15  |
| 50% PROGRESS SET   | 09/28/15 |
| GMP PRICING SET    | 10/14/15 |
| FOUNDATION PACKAGE | 12/07/15 |
| GMP PACKAGE        | 04/03/17 |
| PERMIT SET         | 05/22/17 |

DATE 05/22/2017

JOB NUMBER 1493101

DRAWN BY WJM

CHECKED BY CDF

SHEET TITLE

BUILDING 3000 PLAN -  
PROJECT LEVEL 3

SHEET NUMBER

P1-32

COMMENTS

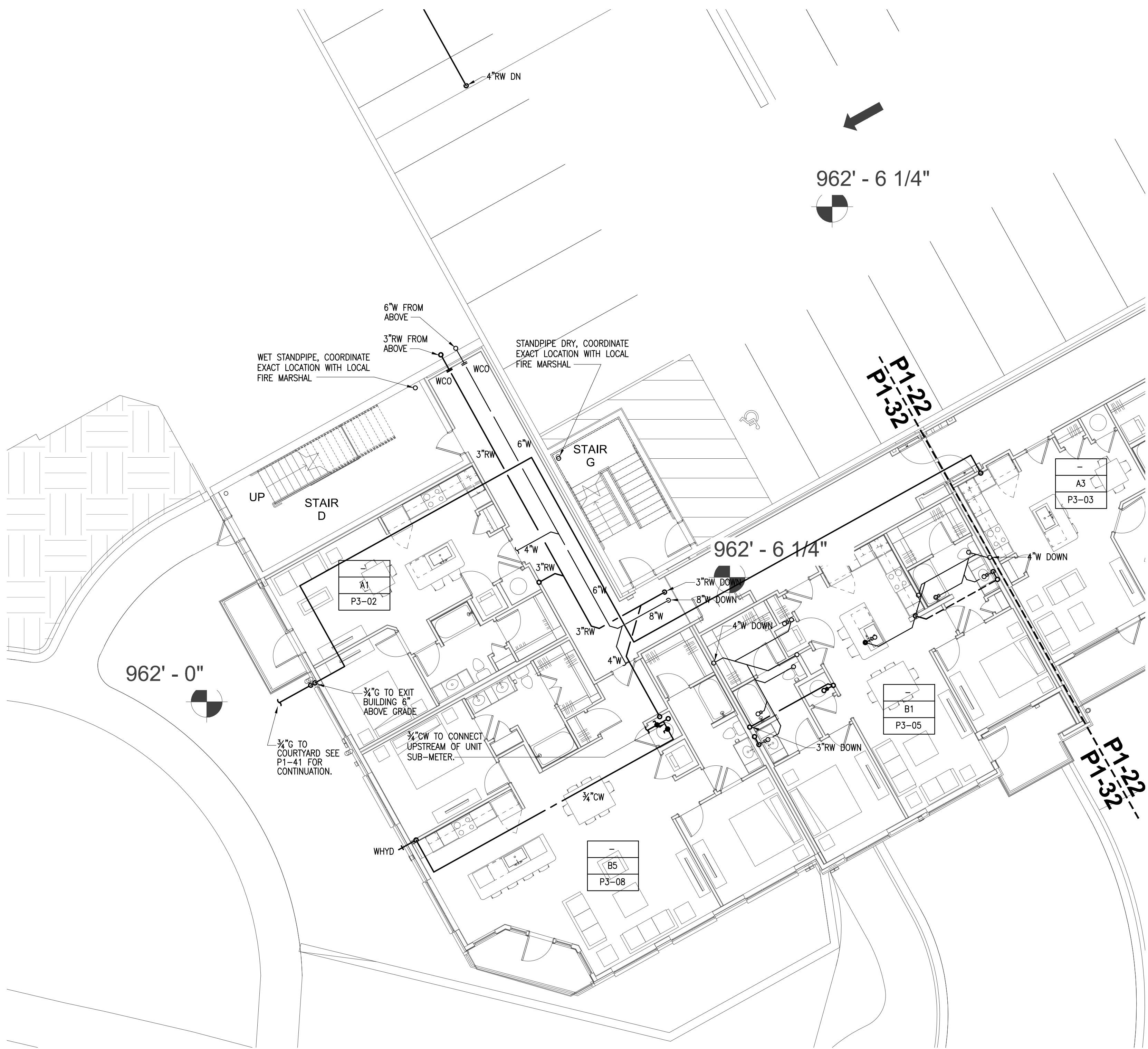

1 BUILDING 3000 PROJECT LEVEL 3  
SCALE: 1/8\"/>

