

4 UNIT A5-HC TOP FLOOR PLAN - S,W&V  
SCALE: 1/4" = 1'-0"

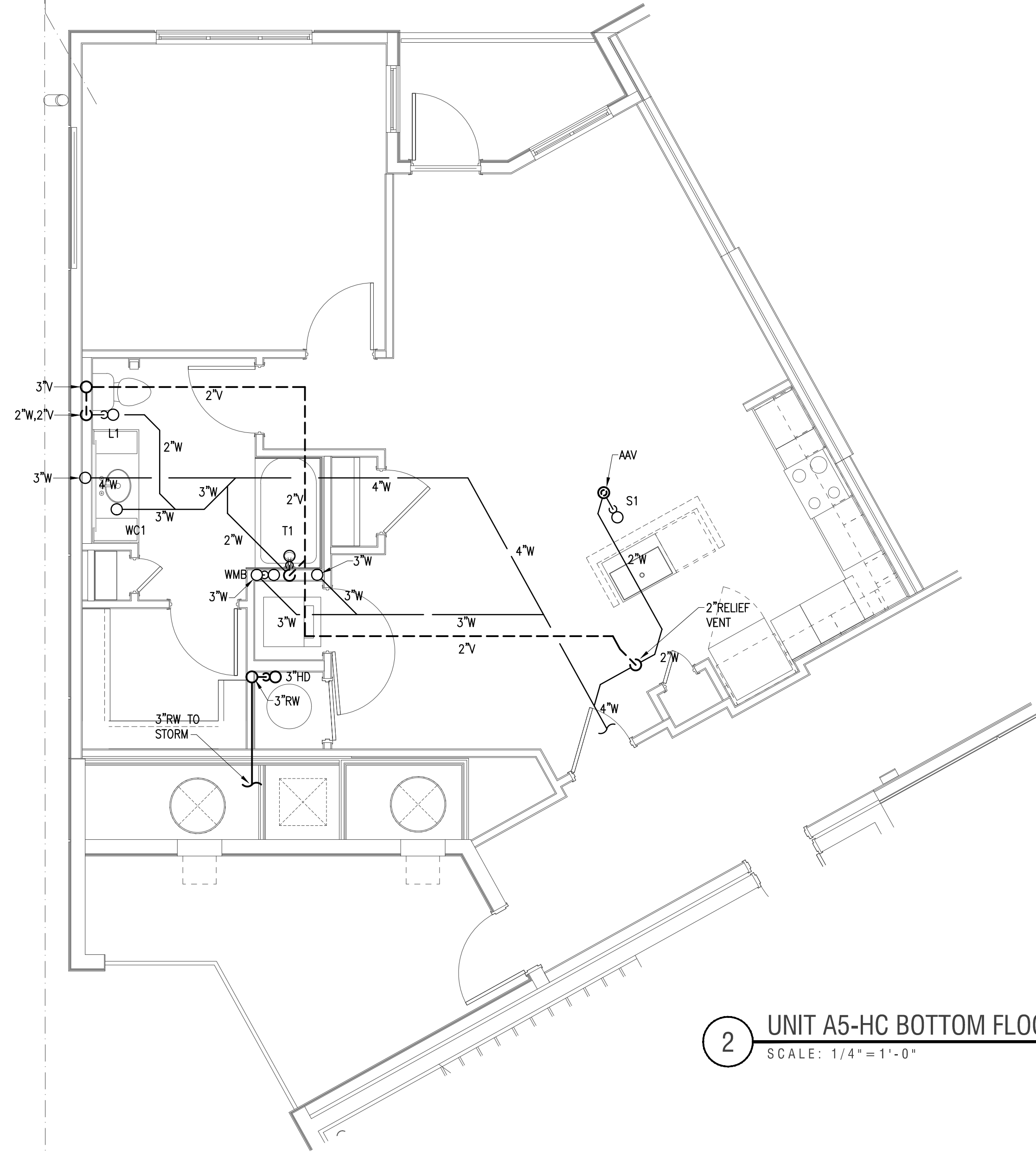

2 UNIT A5-HC BOTTOM FLOOR PLAN - S,W&V  
SCALE: 1/4" = 1'-0"

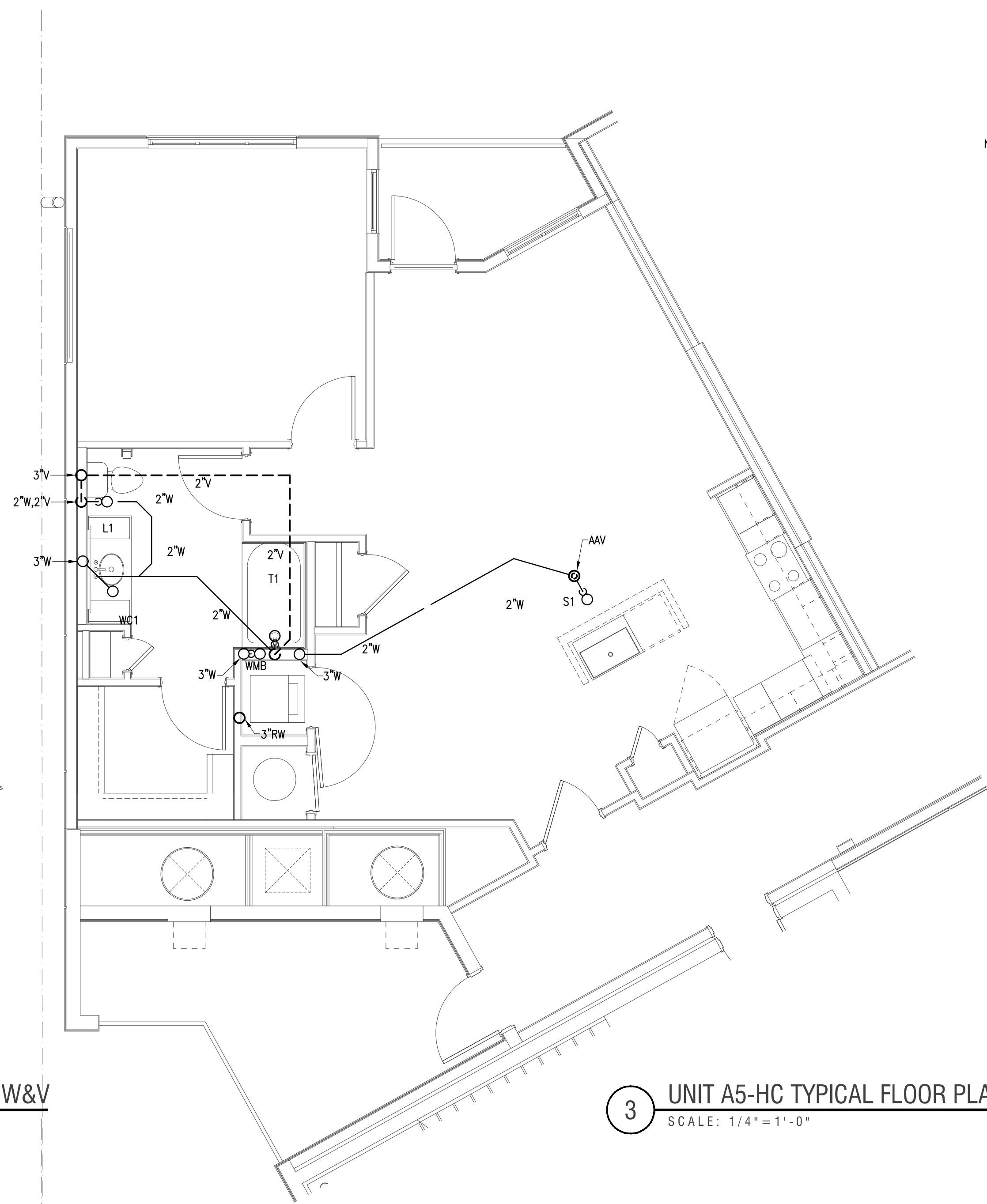

3 UNIT A5-HC TYPICAL FLOOR PLAN - S,W&V  
SCALE: 1/4" = 1'-0"

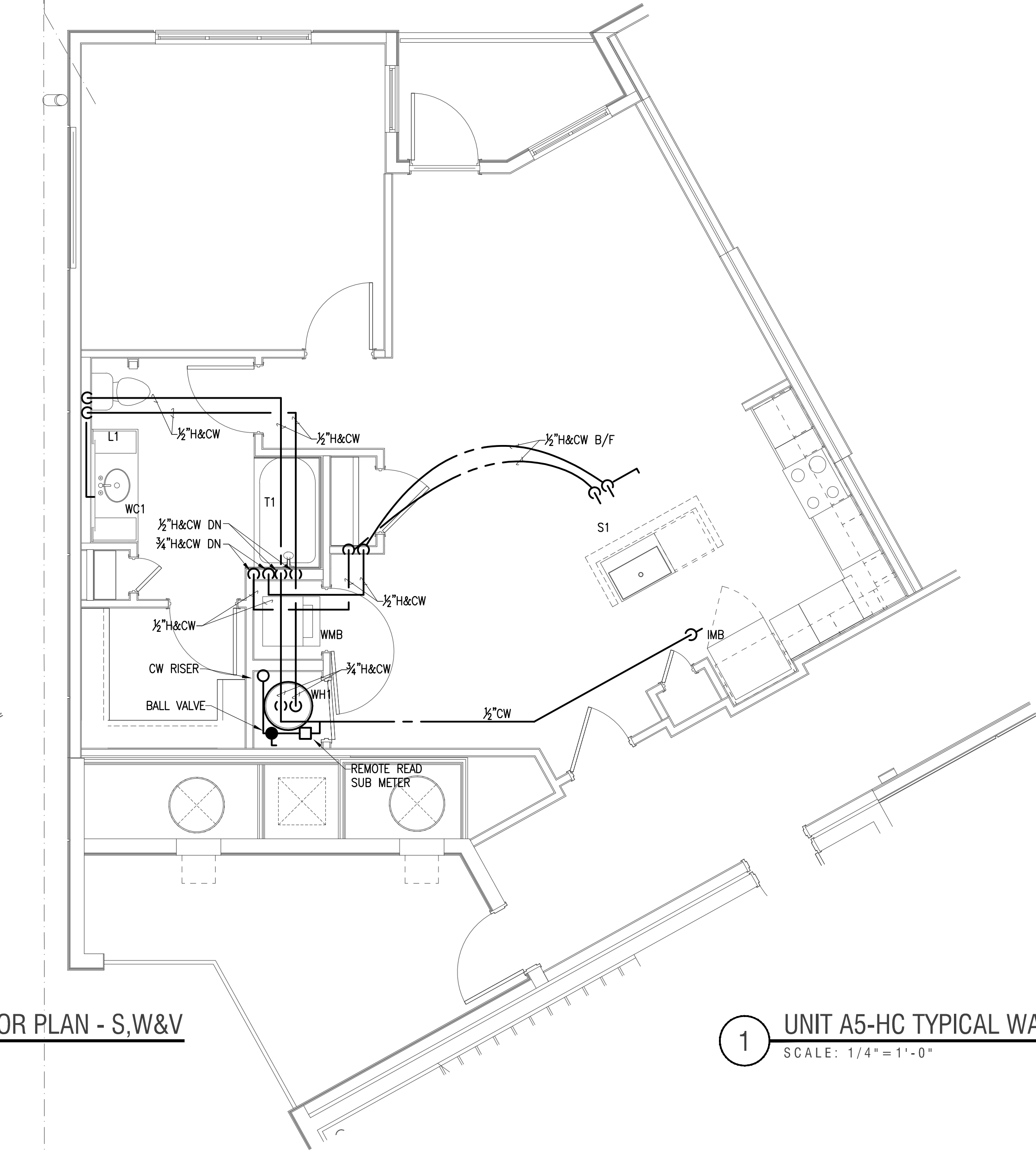

1 UNIT A5-HC TYPICAL WATER  
SCALE: 1/4" = 1'-0"

- NOTES:
- SEE SHEETS P0-01 P0-02 & P0-03 FOR GENERAL NOTES, SCHEDULE AND DETAILS.
  - SEE P1-KK SERIES FOR FLOOR PLANS WASTE, VENT AND WATER PIPING.
  - ISLAND SINKS WITH AIR ADMITTANCE VALVES SHALL HAVE A RELIEF VENT THREE STORIES FROM THE TOP FLOOR AND BELOW.

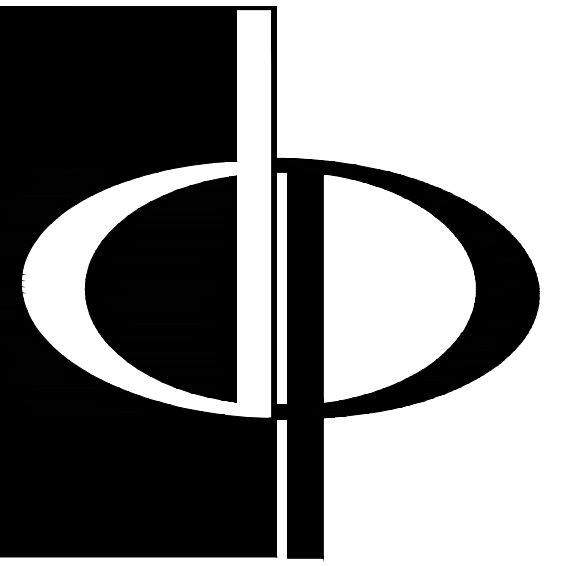

**THE PRESTON  
PARTNERSHIP, LLC**  
A MULTI-DISCIPLINARY DESIGN FIRM

SOUTH TERRACES  
115 PERIMETER CENTER PLACE, SUITE 950  
ATLANTA, GEORGIA 30346  
TELEPHONE: 770.396.7248  
FAX: 770.396.2945

WWW.THEPRESTONPARTNERSHIP.COM  
CONSULTANT

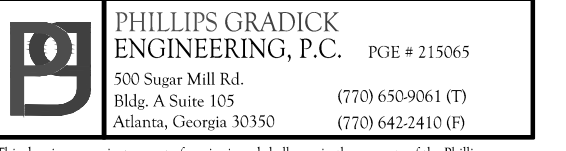

PHILLIPS GRADY  
ENGINEERING, P.C.  
500 Super Mile Rd.  
Atlanta, Georgia 30308  
(770) 640-4000 (TX)  
(770) 640-2400 (TX)

PHILLIPS GRADY ENGINEERING, P.C. and its subsidiaries are not responsible for the design or construction of any project unless specifically stated otherwise. The services provided are for the use of the client and are not to be used for any other purpose without the express written permission of Phillips Grady Engineering, P.C. or its subsidiaries.

SEAL

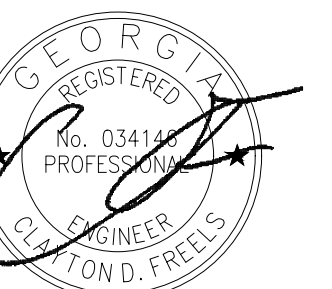

05/03/2017

PROJECT

**REVEL AT THE  
BALLPARK  
PHASE II**

2885 CRESCENT PKWY  
SMYRNA, GA 30080

FOR



**ATLANTIC REALTY  
PARTNERS**

3438 PEACHTREE ROAD  
SUITE 1425  
ATLANTA, GA 30326

ISSUES & REVISIONS

ISSUES & REVISIONS	DATE
CONCEPTUAL DESIGN	8/21/15
50% PROGRESS SET	09/28/15
60% PROGRESS SET	10/14/15
FOUNDATION PACKAGE	12/07/15
60% PACKAGE	04/03/17
PERMIT SET	05/22/17

DATE 05/22/2017

JOB NUMBER 1493101

DRAWN BY WJMJ

CHECKED BY CDF

SHEET TITLE

UNIT PLANS -  
PLUMBING

SHEET NUMBER

**P3-08**

COMMENTS

30X42 © 2017 The Preston Partnership, LLC