



GERBER

VITREOUS CHINA
TOILET
HE-21-519

LAVATORIES

TOILETS

BIDETS / URINALS

CAST IRON



VIPER™ 1.28 ErgoHeight™ Compact Elongated Toilet

12" Rough-in

Features:

- 1.28 gpf/4.8 Lpf high efficiency two-piece toilet
- Elongated ErgoHeight™ bowl
- Compact design fits in round front space
- Dual-fed siphon jet
- Fluidmaster® fill valve
- 3" flush valve
- 2" glazed trapway
- Color matched tank lever
- Available in White and Biscuit
- 2 bolt caps
- ADA Compliant



Dimensions:

Height 29⁷/₈"
Width 18³/₈"
Depth 26⁷/₈"
Rough-in 12"
Water Surface from Rim 6¹/₈"
Trapway (ave)* 2"
Water Surface 9⁷/₈" x 6⁷/₈"
Water Seal 2"
Shipping Weight 77 lbs

Specifications: Bowl—#HE-21-872 Elongated Bowl Tank—#HE-28-570
Seat not included

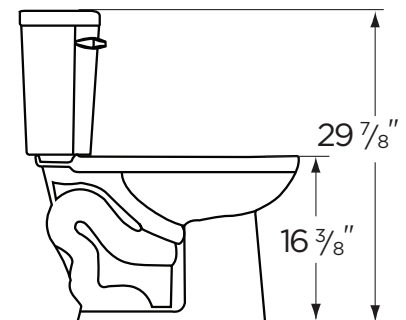
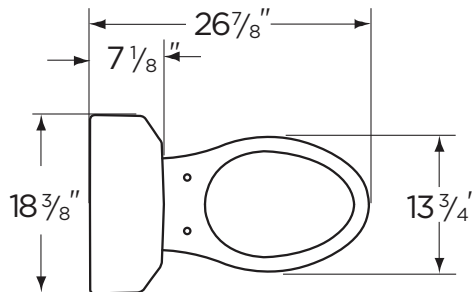

THIS FIXTURE QUALIFIES
ACCORDING TO ASME TEST
PROCEDURES AS A HIGH
EFFICIENCY WATER CLOSET WITH
AN AVERAGE CONSUMPTION OF
1.28 gpf (4.8 Lpf) OR LESS.

HIGH EFFICIENCY TOILET
HET



www.gerberonline.com

Job Name	
Date	
Model Specified	
Quantity	
Customer	
Contractor	
Architect/engineer	

